

Appendix 2

East Dorset Stage 1 Site Maps



Riverside Industrial Estate

This map is based on Ordnance Survey material with the permission of Ordnance Survey on behalf of the Controller of Her Majesty's Stationery Office © Crown copyright.

Unauthorised reproduction infringes Crown copyright and may lead to prosecution or civil proceedings. Licence No. 100024319. 2007.



NORTH
July 2007

ED_IdentifiedEmploymentLand

 Allocated Employment Land: General Industrial / Business Area

East Dorset
District Council

Ferndown Forest

So much to offer

So much to offer

East Dorset
District Council

So much to offer

East Dorset
District Council

offer

Ferndown Industrial Estate



This map is based on Ordnance Survey material with the permission of Ordnance Survey on behalf of the Controller of Her Majesty's Stationery Office © Crown copyright.

Unauthorised reproduction infringes Crown copyright and may lead to prosecution or civil proceedings.
Licence No. 100024319. 2007.



NORTH
July 2007

ED_IdentifiedEmploymentLand Legend

-  Allocated Employment Land Without Planning Permission, Not Under Construction And Not Completed : General Industrial / Business Area
-  Allocated Employment Land: General Industrial / Business Area
-  Allocated Employment Land: High Quality Business Park

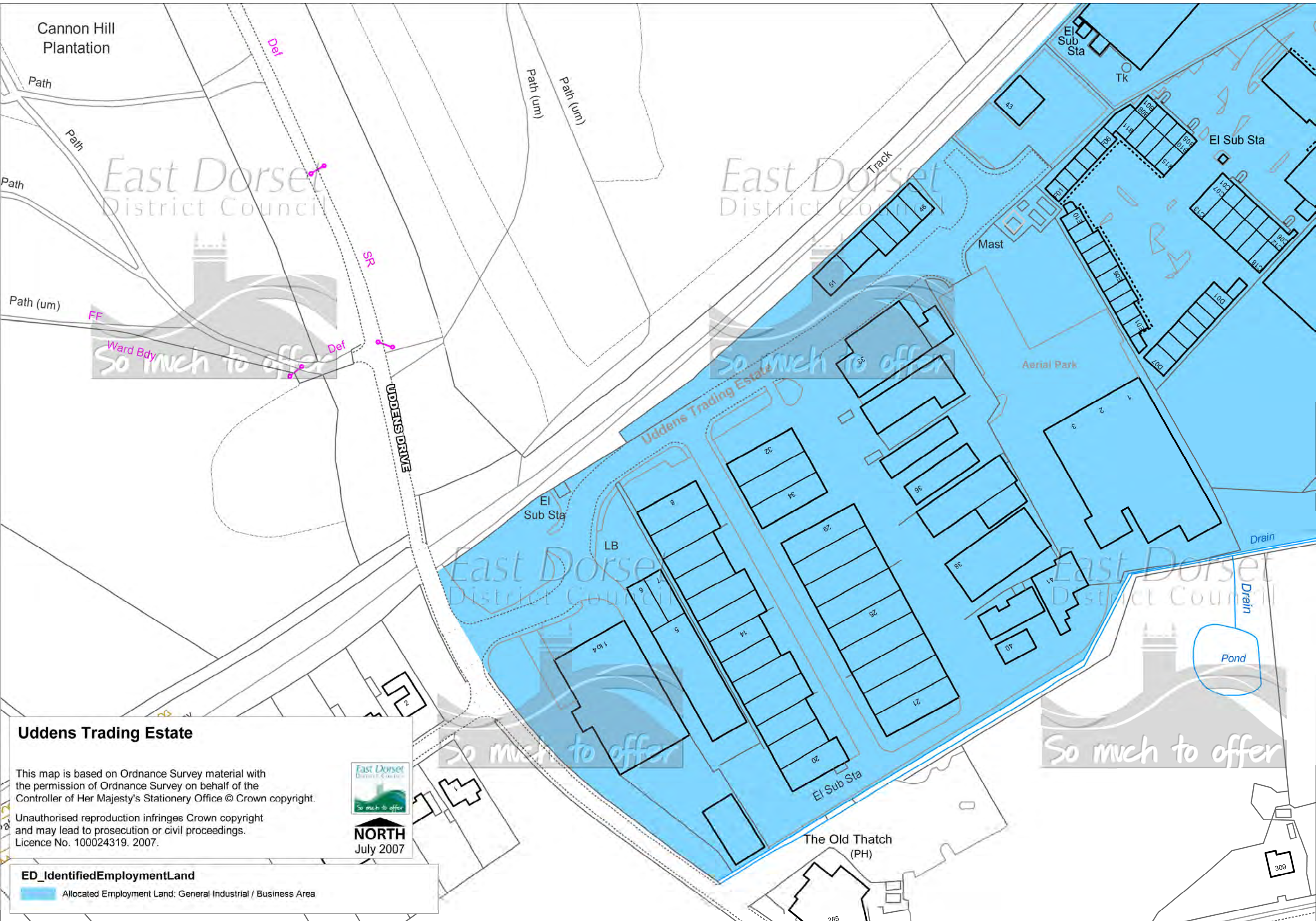

Uddens Trading Estate

This map is based on Ordnance Survey material with the permission of Ordnance Survey on behalf of the Controller of Her Majesty's Stationery Office © Crown copyright.

Unauthorised reproduction infringes Crown copyright and may lead to prosecution or civil proceedings. Licence No. 100024319. 2007.



ED_IdentifiedEmploymentLand

Allocated Employment Land: General Industrial / Business Area

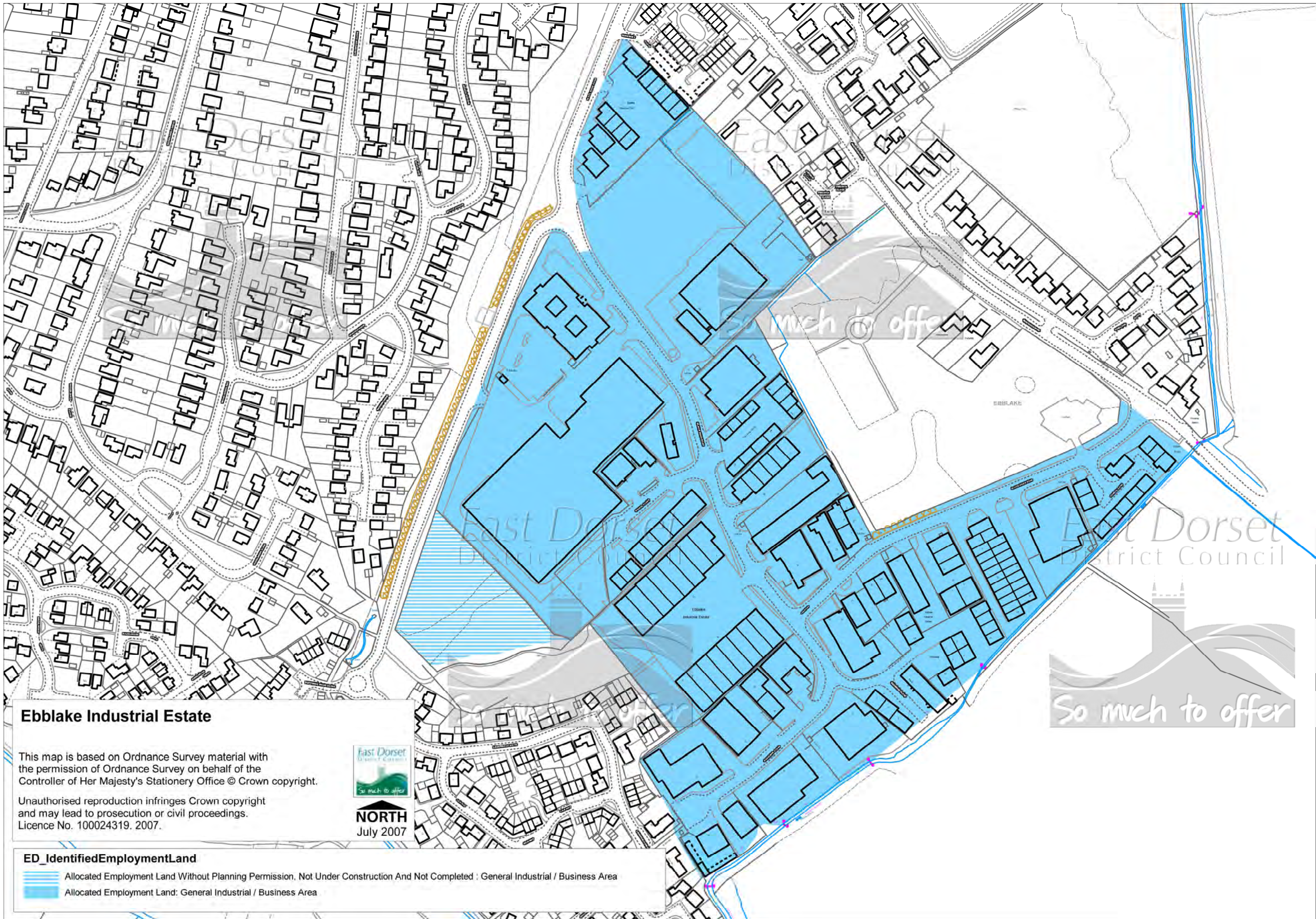



Ebble Industrial Estate

This map is based on Ordnance Survey material with the permission of Ordnance Survey on behalf of the Controller of Her Majesty's Stationery Office © Crown copyright.

Unauthorised reproduction infringes Crown copyright and may lead to prosecution or civil proceedings. Licence No. 100024319. 2007.



ED_ IdentifiedEmploymentLand

-  Allocated Employment Land Without Planning Permission, Not Under Construction And Not Completed : General Industrial / Business Area
-  Allocated Employment Land: General Industrial / Business Area







Brook Road Industrial Area

This map is based on Ordnance Survey material with the permission of Ordnance Survey on behalf of the Controller of Her Majesty's Stationery Office © Crown copyright.

Unauthorised reproduction infringes Crown copyright and may lead to prosecution or civil proceedings. Licence No. 100024319. 2007.



ED_IdentifiedEmploymentLand

-  Allocated Employment Land Without Planning Permission, Not Under Construction And Not Completed : General Industrial / Business Area
-  Allocated Employment Land: General Industrial / Business Area

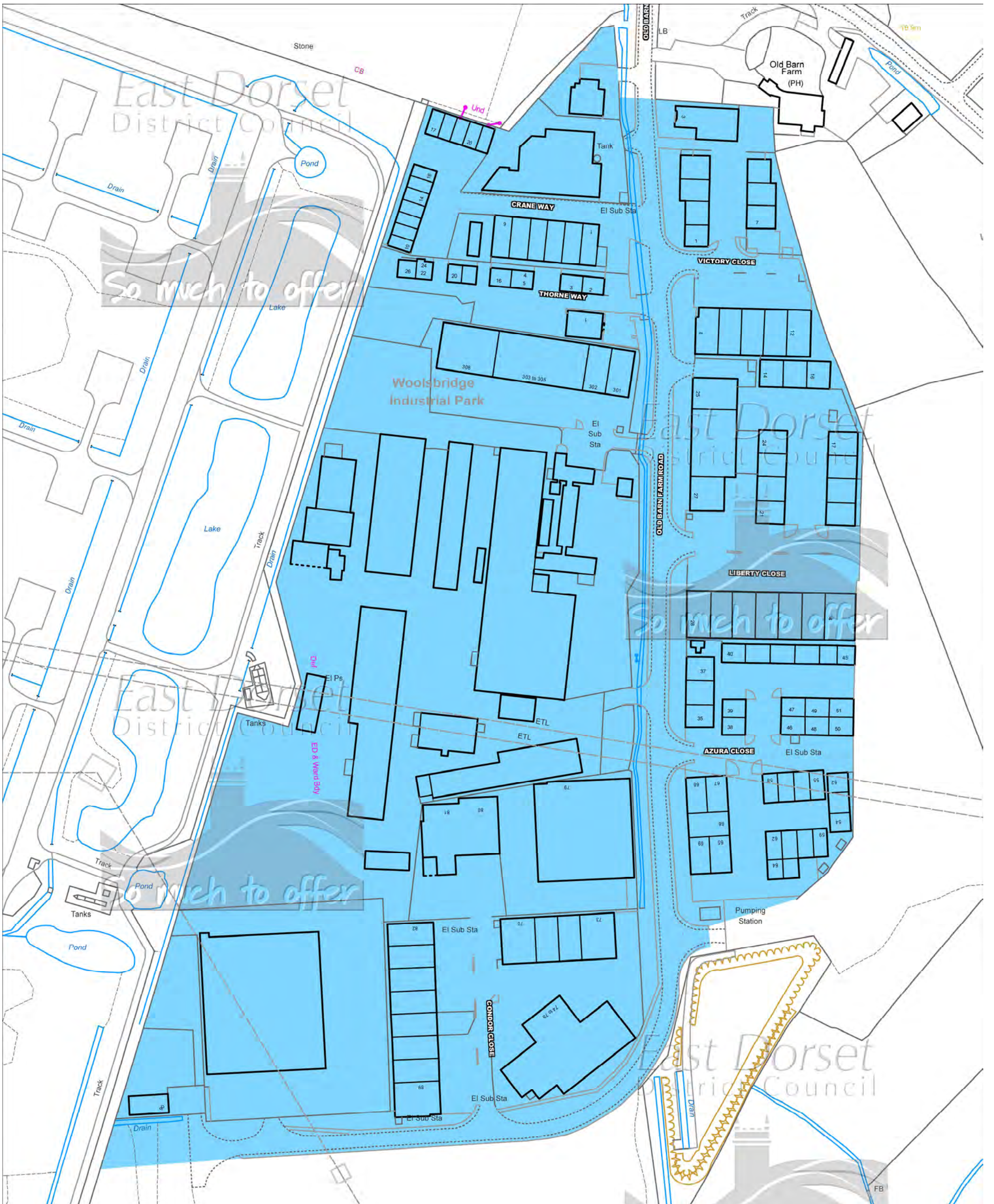

Woolsbridge Industrial Estate

This map is based on Ordnance Survey material with the permission of Ordnance Survey on behalf of the Controller of Her Majesty's Stationery Office © Crown copyright.

Unauthorised reproduction infringes Crown copyright and may lead to prosecution or civil proceedings. Licence No. 100024319. 2007.



ED_IdentifiedEmploymentLand

Allocated Employment Land: General Industrial / Business Area

So much to offer

d Railway

Kingfisher Park

Drain

Gundrymor

Depot

East Dorset District Council

East Dorset District Council



GOLLINGWOOD ROAD

Heathfield Cottage

THREE CROSS ROAD

Minster Park

7 to 10

So much to offer

1 2 3 4 5 6

22 21 20 19

18 17

East Dorset District Council

East Dorset District Council

FAP

Drain

Drain

Drain

Gundrymor Industrial Estate

This map is based on Ordnance Survey material with the permission of Ordnance Survey on behalf of the Controller of Her Majesty's Stationery Office © Crown copyright.

Unauthorised reproduction infringes Crown copyright and may lead to prosecution or civil proceedings. Licence No. 100024319. 2007.



ED_IdentifiedEmploymentLand

Allocated Employment Land: General Industrial / Business Area

So much to offer

So much to offer

Pond

Pond

Stone LB



Balie Gate Industrial Estate

This map is based on Ordnance Survey material with the permission of Ordnance Survey on behalf of the Controller of Her Majesty's Stationery Office © Crown copyright.

Unauthorised reproduction infringes Crown copyright and may lead to prosecution or civil proceedings. Licence No. 100024319. 2007.



ED_ IdentifiedEmploymentLand

Allocated Employment Land: General Industrial / Business Area

So much to offer

So much to offer