

NOTICE OF CONFIRMATION OF PUBLIC PATH ORDER
HIGHWAYS ACT 1980
WEST DORSET DISTRICT COUNCIL
WEST DORSET DISTRICT (MELCOMBE HORSEY FOOTPATH 16)
PUBLIC PATH DIVERSION ORDER 1987

On 15th February 1988 the West Dorset District Council confirmed the above-named Order.

The effect of the Order, as confirmed, is to divert the whole of Melcombe Horsey Footpath 16 which runs from map reference 75480137 on the unclassified County road generally westwards for 1000 metres to map reference 74500145 on Melcombe Horsey Bridleway 8 to a new line running southwestwards from map reference 75480137 for 70 metres, crossing the parish boundary at map reference 75430133 and continuing, as Cheselbourne Footpath 25, southwestwards then westwards for 300 metres along the northern boundary of Field OS 2200, returning to the parish of Melcombe Horsey over a stile at map reference 75150125 into Field OS 9930 and running northwards for 60 metres then west-northwestwards along the northern boundary of that field for 375 metres, then southwestwards for 15 metres, through a gate into Field OS 7458 and, after skirting the northeastern corner of Field OS 7029, entering that field through a further gate and running westwards along its northern boundary for 250 metres and finally southwards for 20 metres to emerge onto Melcombe Horsey Bridleway 8 at map reference 74530138.

A copy of the Order as confirmed and the map contained in it has been deposited and may be inspected free of charge at the Council Offices, 58/60 High West Street, Dorchester, Dorset, between 9.00 a.m and 4.30 p.m Mondays to Fridays. Copies of the Order and map may be purchased.

The Order becomes operative as from 19th February 1988 but if a person aggrieved by the Order desires to question the validity thereof, or of any provisions contained therein, on the ground that it is not within the powers of the Highways Act 1980 or on the ground that any requirement of the Act, or of any regulation made thereunder, has not been complied with in relation to the Order he may, under paragraph 2 of Schedule 2 as applied by paragraph 5 of Schedule 6 to the Act, within six weeks from 19th February 1988 make an application for the purpose to the High Court.

Dated this 19th day of February 1988.

M B TAYLOR
Chief Executive

58/60 High West Street,
Dorchester,
Dorset.
DT1 1UZ

PUBLIC PATH DIVERSION ORDER
HIGHWAYS ACT, 1980
WEST DORSET DISTRICT COUNCIL
WEST DORSET DISTRICT (MELCOMBE HORSEY FOOTPATH 16)
PUBLIC PATH DIVERSION ORDER, 1987

WHEREAS it appears to the WEST DORSET DISTRICT COUNCIL as respects the footpath referred to in paragraph 1 of this Order that in the interests of the owner of the land crossed by the path and the public it is expedient that the line of the path should be diverted;

AND WHEREAS the said owner has agreed to defray any compensation which becomes payable in consequence of the coming into operation of this order and any expenses which are incurred in bringing the new site of the path way into a fit condition for use by the public:

AND WHEREAS the DORSET COUNTY COUNCIL have been consulted in pursuance of section 120(2) of the Highways Act 1980 (hereinafter called 'the 1980 Act');

AND WHEREAS the DORSET COUNTY COUNCIL have consented to the making of this order in pursuance of section 120(2) of the Highways Act, 1980.

NOW THEREFORE the WEST DORSET DISTRICT COUNCIL in pursuance of the powers in that behalf conferred by section 119 of the 1980 Act hereby make the following order:

1. The public right of way over the land situate at Melcombe Horsey in the District of West Dorset shown by a solid black line on the map annexed hereto and described in A of the schedule hereto shall be extinguished at the expiration of twenty-eight days from the date of confirmation of this order.
2. Where immediately before the date on which a highway is diverted in pursuance of this order there is apparatus under, in, on, along or across that highway belonging to statutory undertakers for the purpose of carrying on their undertaking, the undertakers shall continue to have the same rights in respect of the apparatus as they then had.
3. There shall be at the expiration of twenty-eight days from the date of confirmation of this order a public footpath over the land situate at Melcombe Horsey aforesaid and Cheselbourne in the said District described in B of the schedule hereto and shown by a broken black line on the map contained in this order.
4. This order may be cited as the West Dorset District (Melcombe Horsey Footpath 16) Public Path Diversion Order, 1987

The COMMON SEAL of the said)
WEST DORSET DISTRICT COUNCIL was)
hereunto affixed this 24th)
day of December 1987 in the)
presence of)

L.S.

E.H.KING
CHAIRMAN

M.B.TAYLOR
CHIEF EXECUTIVE

SCHEDULE

A

DESCRIPTION OF SITE OF EXISTING PATH OR WAY

Section of path or way as indicated on map	Position and length	Width
A - B (WHOLE PATH)	<u>Melcombe Horsey Footpath 16</u> From a point at map reference 75480137 on the unclassified County road running generally westwards for 1000 metres to map reference 74500145 on Melcombe Horsey Bridleway 8	1.5 metres

B

DESCRIPTION OF SITE OF NEW PATH OR WAY

Section of path or way as indicated on map	Position and length	Width
A - E	<u>Melcombe Horsey Footpath 2123</u> From the said point at map reference 75480137 running approximately south westwards for 70 metres to the parish boundary at map reference 75430133	1.5 metres
E - D	<u>Cheselbourne Footpath 25</u> From the said parish boundary at map reference 75430133 running south westwards then westwards for 300 metres along the northern boundary of Field OS 2200 to a stile at map reference 75150125	1.5 metres
D - C	<u>Melcombe Horsey Footpath 16</u> Crossing the stile and the parish boundary at map reference 75150125 into Field OS 9930 and running northwards for 60 metres then west-north-westwards along the northern boundary of that field for 375 metres then south-westwards for 15 metres, through a gate into Field OS 7458 and, after skirting the north-eastern corner of Field OS 7029 entering that field through a further gate and running westwards along its northern boundary for 250 metres and finally southwards for 20 metres to emerge onto Melcombe Horsey Bridleway 8 at map reference 74530138.	1.5 metres

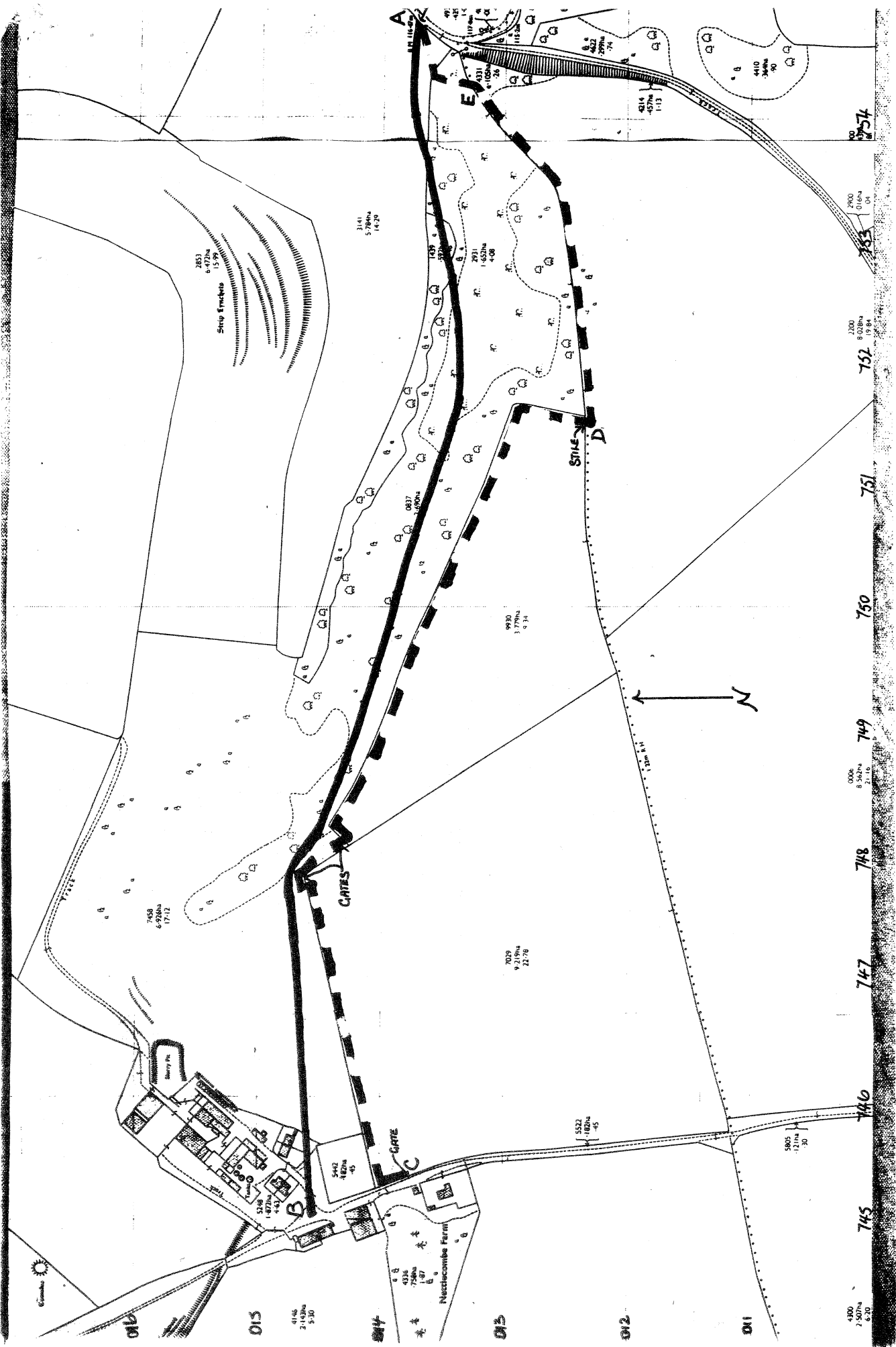

O16

O15

O14

O13

O12

O11

Nettlecombe Farm

GATES

GATE

STAIRS

Ship Tracks

4300 7.50ha 18.8

520

5805 12.1ha 30

745

746

747

748

749

750

751

752

753

754

755

756

757

758

759

760

761

762

763

764

765

766

767

768

769

770

771

772

773

774

775

776

777

778

779

780

781

782

783

784

785

786

787

788

789

790

791

792

793

794

795

796

797

798

799

800

DATED 24th December

1987

HIGHWAYS ACT, 1980

WEST DORSET DISTRICT
(MELCOMBE HORSEY FOOTPATH 16)

PUBLIC PATH DIVERSION ORDER, 1987