

Response ID [REDACTED]

Submitted to Weymouth Neighbourhood Plan 2021 to 2038

Submitted on 2025-04-09 14:39:28

Part 1: personal details

1 Are you responding on behalf of yourself or for someone else?

I'm responding on behalf of myself

2 What is your name?

Name:

Cllr David Northam

3 What is your email address?

Email:

[REDACTED]

4 What is your job title and organisation?

Organisation:

Weymouth Town Council

Job title:

Councillor

5 What is your address?

Address:

[REDACTED]

[REDACTED]

[REDACTED]

Postcode:

[REDACTED]

6 What is your phone number?

Phone number:

[REDACTED]

Part 2: your representation

8 Please write your comments / representation in the box below

Comments:

Submission Plan document W23A: Lodmoor Old Tip North- This land is owned by Dorset Council. However it has only recently been identified to me that the southern half of W23A is leased to Weymouth Town Council as part of their managed area within Lodmoor Country Park. The policy identifies use as Light industrial Use in this context this should nclude using the site for parks and gardens vehicle and/or equipment storage and/or erection polytunnels for plant propagation and growth to support the public gardens.

The area leased by WTC is highlighted in blue on the attached map.

9 Would you like to attach a file in relation to your response?

File upload:

No file uploaded

10 Do you wish to be notified of Dorset Council's decision to 'make' or refuse to 'make' the neighbourhood plan at the Regulation 19 stage?

Yes

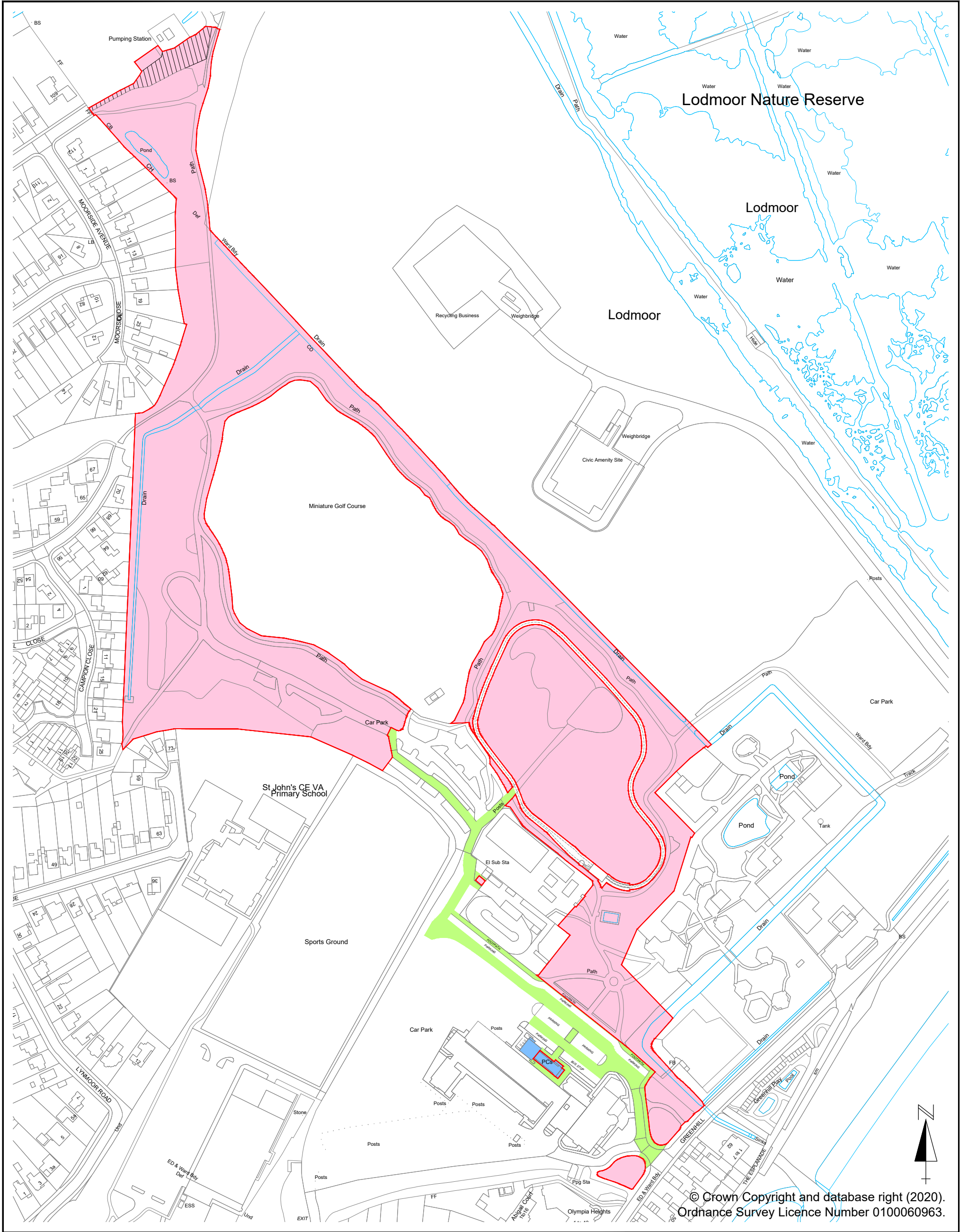

**Lodmoor Country Park,
Weymouth
Plan 1**

South Walks House,
South Walks Road,
DORCHESTER,
Dorset.
DT1 1UZ
Tel: 01305 251010

Date : 07-07-20
Scale 1 : 2500 @ A3