

Notes
 Do not scale from this document, unless for the purposes of planning applications where a scale bar is provided. Refer to figured dimensions only. All dimensions to be verified on site prior to construction. Report all discrepancies or ambiguities to the Document Originator immediately. This document is to be read in conjunction with relevant documents, drawings and standards.

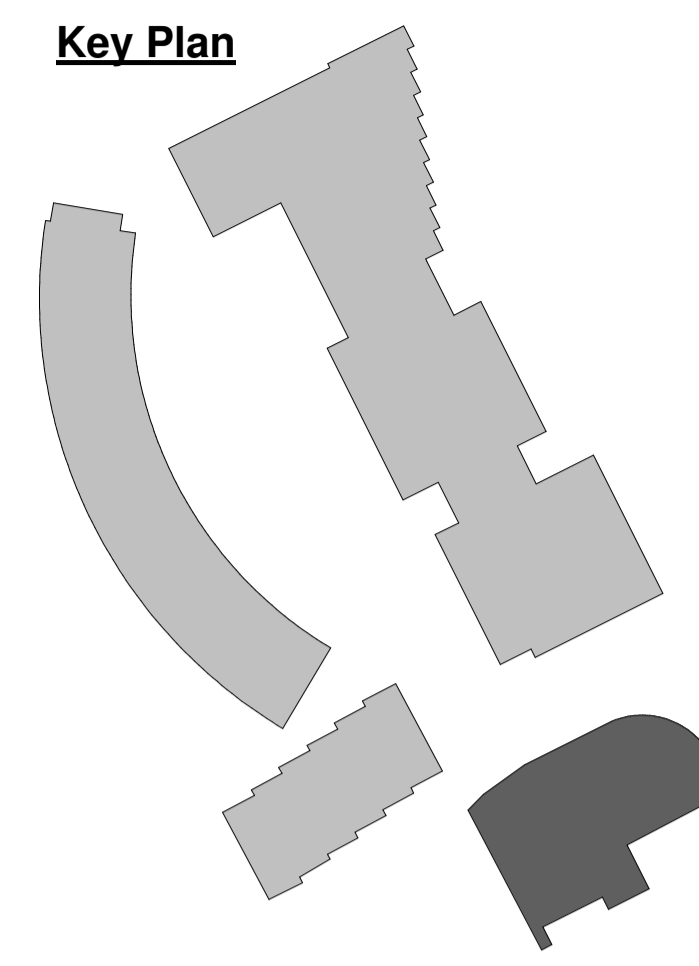

- Proposed Materials**
- 01 Curtain Wall Glazing - Dark Grey Stick System with Expressed Vertical Mullions & Matching Doorsets
 - 02 Purbeck Stone Wall - Mixed Size and Colour Rubble Walling
 - 03 Light Grey Cast Stone Lintel
 - 04 Vertical Shiplap Grey Timber Cladding
 - 05 Shiplap Grey Timber Cladding to Soffit
 - 06 Dark Grey Aluminium Doors and Windows
 - 07 Green Wall
 - 08 Extensive Green Roof
 - 09 Mansafe System
 - 10 Stone Paving
 - 11 Tiled finish to pool with perimeter slot drain
 - 12 Dark Grey Render
 - 13 Roof access hatch
 - 14 Aluminium louvre as part of curtain wall system
 - 15 Aluminium louvre to soffit
 - 16 Hi & miss timber screen

P04 10/10/22 ISSUED FOR PLANNING GCT MAS

Rev	Date	Notes	Dm	Chk'd

SCALE 1:100

Document Originator
AWW
 London 106 Weston Street, SE1 3QB 020 7160 6000
 Plymouth East Quay House, PL4 0HX 01752 261 262
 Bristol plot + mark, 48-52 Baldwin Street, BS1 1QB 0117 923 2535
 RIBA Chartered Practice www.aww-uk.com

Client
 Kingfisher Resorts Studland Ltd

AWW Project Number 4561 Project Stage STAGE 2

Project Title
 Knoll House Hotel Studland

Title
 Spa - Lower Ground Floor

Scale @ A1 Document Status

Project	Origin	Volume	Level	Type	Role	Number	Rev
4561	AWW	T2	LG	DR	A	10001	P04

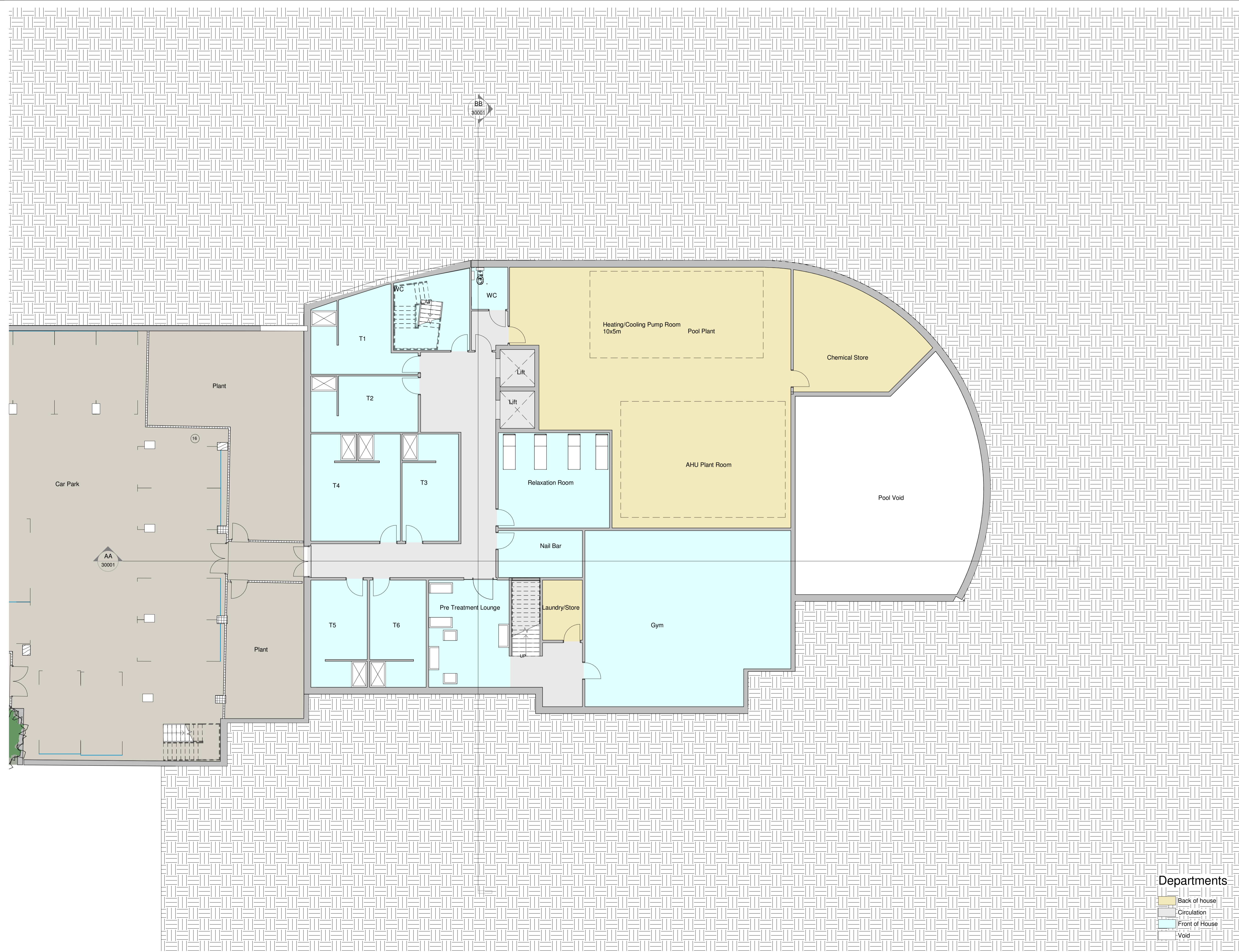

- Departments**
- Back of house
 - Circulation
 - Front of House
 - Void

Spa - Lower Ground Floor
 1 : 100