

For office use only

Batch number: _____

Received: _____

Representor ID # _____

Ack: _____

Representation # _____



North Dorset Local Plan – 2011 to 2026 Part 1

Pre-submission Focused Changes Consultation

1 August to 12 September 2014

Regulation 19 of Town and Country Planning (Local Planning) (England) Regulations 2012

Response Form

For each representation you wish to make a separate response form will need to be completed.

This is a formal consultation on the legal compliance and soundness of the Local Plan as amended by focused changes, before it is submitted to the Secretary of State for examination by an Inspector. For advice on how to respond to the consultation and fill in this form please see the 'Guidance Notes for Making Representations' that can be found on the Council's website at

www.dorsetforyou.com/focusedchangesconsultation/north

Please return completed forms to:

Email: planningpolicy@north-dorset.gov.uk

Post: Planning Policy, North Dorset District Council, Nordon, Salisbury Road, Blandford Forum, Dorset DT11 7LL

Alternatively you can submit your comments online at:

www.surveymonkey.com/s/NorthDorsetLocalPlanFocusedChangesConsultation

Deadline: 11:59 p m on 12 September 2014. Representations received after this time may not be accepted.

Part A – Personal details

This part of the form must be completed by all people making representations as **anonymous comments cannot be accepted**. Representations cannot be treated in confidence as Regulation 22 of the Town and County Planning (Local Planning) (England) Regulations 2012 requires copies of all representations to be made publically available. By submitting this response form you consent to your information being disclosed to third parties for this purpose, but signatures, private telephone numbers and e-mail addresses or private addresses will not be visible on our web site, although they will be shown on paper copies that will be sent to the Inspector and available for inspection.

*If an agent is appointed, please complete only the Title, Name and Organisation boxes to the personal details but complete the full contact details of the agent. All correspondence will be sent to the agent.

Personal Details (if applicable)*	Agent's Details (if applicable)*
Title	
First Name	
Last Name	
Job Title(<i>where relevant</i>)	
Organisation (<i>where relevant</i>)	
Address	
Postcode	
Tel. No.	
Email Address	

Part B – Representation

The Focused Changes to the North Dorset Local Plan 2011 to 2026 Part 1 and its supporting documents have been published in order for representations to be made prior to submission to the Secretary of State for examination. The purpose of the examination is to consider whether the Local Plan as amended by focused changes, complies with the **legal requirements** and is **‘sound’**.

If you are seeking to make a representation on the **way** in which the focused changes have been prepared it is likely that your comments or objections will relate to a matter of **legal compliance**.

If you are seeking to make representations on the **content** of the focused changes it is likely that your comments or objections relate to the **soundness** of the plan and whether it is justified, effective or consistent with national policy.

Further information on the matter of legal compliance and the issue of soundness can be found in the ‘Guidance Notes for Making Representations’.

If you need help completing the response form please see a member of the Planning Policy Team at the consultation exhibition in Blandford Forum on 14 August 2014 or call 01258 484201.

1. Please select which document you are commenting on:

North Dorset Local Plan 2011 to 2026 Part 1: Pre- Submission Focused Changes
(please complete Questions 2 to 9)

Supplement to the Sustainability Appraisal Report (please complete Questions 2 and 10)

2. Please state to which pre-submission focused change you are commenting on:

Change Reference:	Section reference:
-------------------	--------------------

3. Do you consider the Local Plan as amended by focused changes, to be legally compliant and prepared in accordance with the Duty to Cooperate, legal and procedural requirements?

Yes

No

4. Do you consider the Local Plan as amended by focused changes, to be ‘sound’?

Yes

No

5. If you consider the Local Plan as amended by focused changes, to be unsound please specify your reason(s) by ticking the box(es) that apply below

- It has not been positively prepared
- It is not justified
- It is not effective
- It is not consistent with national policy

6. Please give specific details of why you consider the Local Plan as amended by focused changes, has not been prepared in accordance with the Duty to Co-operate, legal or procedural requirement or why you consider the plan to be unsound. Alternatively, if you wish to support any aspects of the plan please also use this box to set out your comments.

Continue on a separate sheet if necessary

7. What change(s) do you consider are necessary to ensure that the Local Plan is legally compliant and sound? It would be helpful if you are able to put forward your suggested revised wording of any policy or text. Please be as precise as possible.

Continue on a separate sheet if necessary

8. If your representation is seeking a change to the Local Plan as amended by the focused changes, do you consider it necessary to participate in the oral part of the examination?

No, I do not wish to participate in the oral examination

Yes, I would like to participate in the oral examination

9. If you wish to participate in the oral part of the examination please outline why you consider that to be necessary. Please note that the Inspector determines who is heard at the examination.

10. Please outline your comments on the Supplement to the Sustainability Appraisal or Addendum to the Habitats Regulations Assessment. Comments are not confined to 'soundness' issues, but respondents can express their opinions on the above documents and use it as a reference point on the 'soundness' of the Local Plan.

11. Do you wish to be notified of any of the following? Please tick all that apply. We will contact you using the details you have given above.

- That the Local Plan Part 1, as amended by the Focused Changes, has been submitted for independent examination
- The publication of the recommendations of any person appointed to carry out an independent examination of the Local Plan Part 1
- The adoption of the Local Plan Part 1.

Signature: _____

Date: _____

If submitting the form electronically, no signature is required.

Additional Text – Focused Changes Malcolm Brown Ref INSET 16

The Respondents welcome proposed change ref: MAJ/16/1 and MAJ/16/12 in the proposed changes to the Proposals Map Inset/16/1.

I have to express some confusion with regard to the identification of the land for housing with various references to south-east and west of Blandford St Mary. It seems to me that the site now proposed for housing lies predominantly south of Blandford St Mary and I think it would be clearer if it was referred to in that way throughout the document.

In that respect, I suggest a further amendment to page 193 (b) to delete 'east' and (h) delete 'east' and again in (s).

The amendments to the inset diagram are supported.

It is noted that the consequential changes reflect only an increase in housing land supply for Blandford which in part also increases the number of affordable housing units. Those amendments are supported.

With regard to change CON/16/3, the second bullet point should be amended to delete the word 'east'. The site has capability of accommodating at least the 300 dwellings proposed, substantial open space including strategic landscape planting and attendant facilities.

With regard to CON/16/5, I would draw your attention to the agreement with the highway authority in 2007 to divert the trailway (National Cycle Network Route 25) from the line of the former railway, South west to north east along Ward's Drove and then alongside the A350 (Poole Road) to the junction with the A354 Blandford by-pass. (plans attached). All of the respondent's proposals since 2007 have been based on that agreement. The agreed route has the advantage that residents of and visitors to Lower Blandford St. Mary need only cross the A350 to join the trailway.

We suggest that the supporting text at paragraph 8.42 should be re-worded to accord with the wording of Policy 16 (r) to include the words "or close to" before "the route of the former Somerset and Dorset railway line".

With regard to change reference MAP/2/1, it should be made clear that the deletion of land safeguarded for the proposed by-pass includes the roundabout shown on that map. A second arrow from the text box will make that clear.

The consequential change to Policy 6, Housing Distribution, is accepted.

With regard to the tracked changes at paragraph 8.42, insert after 'trailway on' 'or close to'. The attached drawings nos. 12169.28 P2, 29 P2, 35P2 and 36 P3 illustrate the way in which the scheme for the development of the site is evolving and taking into account the Landscape Visual Impact Assessment and the Transport Assessment. This indicates a higher density development on the lower land and a looser form of development on the rising land with a substantial tree belt towards the ridge on the west of the site. There is also substantial landscaping adjacent to the roundabout. A surface level crossing of the A354 west of the roundabout is proposed with "Toucan Crossing". The preliminary sketch proposals demonstrate the scale of housing in relation to the scale of trees on the site. The distinctive clump of trees in the centre of the site is retained within an open

space retaining its prominence in the landscape. The frontage to both roads is enclosed with hedges and hedgerow trees. Strategic planting within the development will mitigate any adverse impact on the landscape.

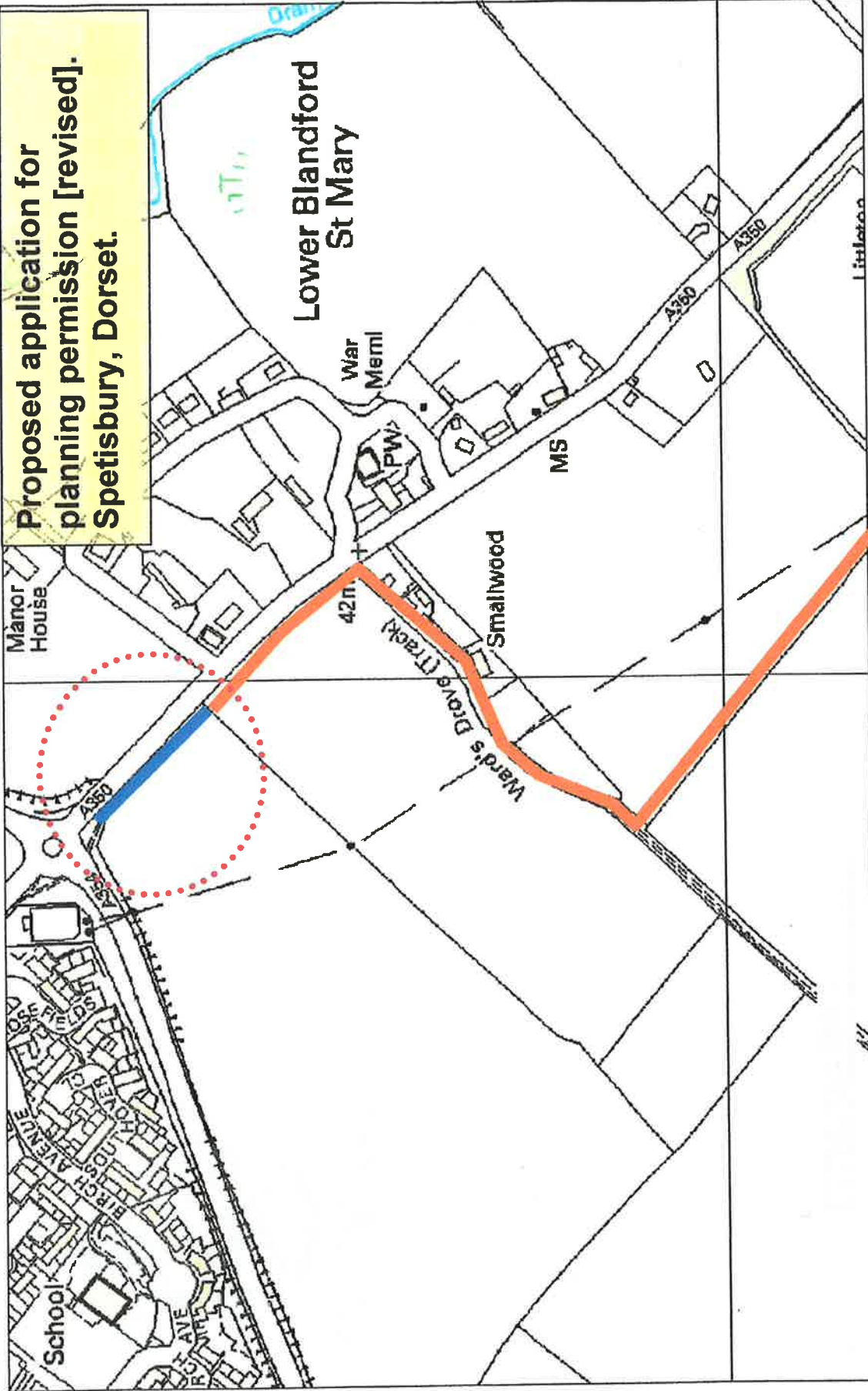

**Proposed application for
planning permission [revised].
Spetisbury, Dorset.**

Date 6/9/2007

Scale 1:414
Centre = 386668 E 105220 N

Crown Copyright © Licence Number LA 100019790.



PLAN A

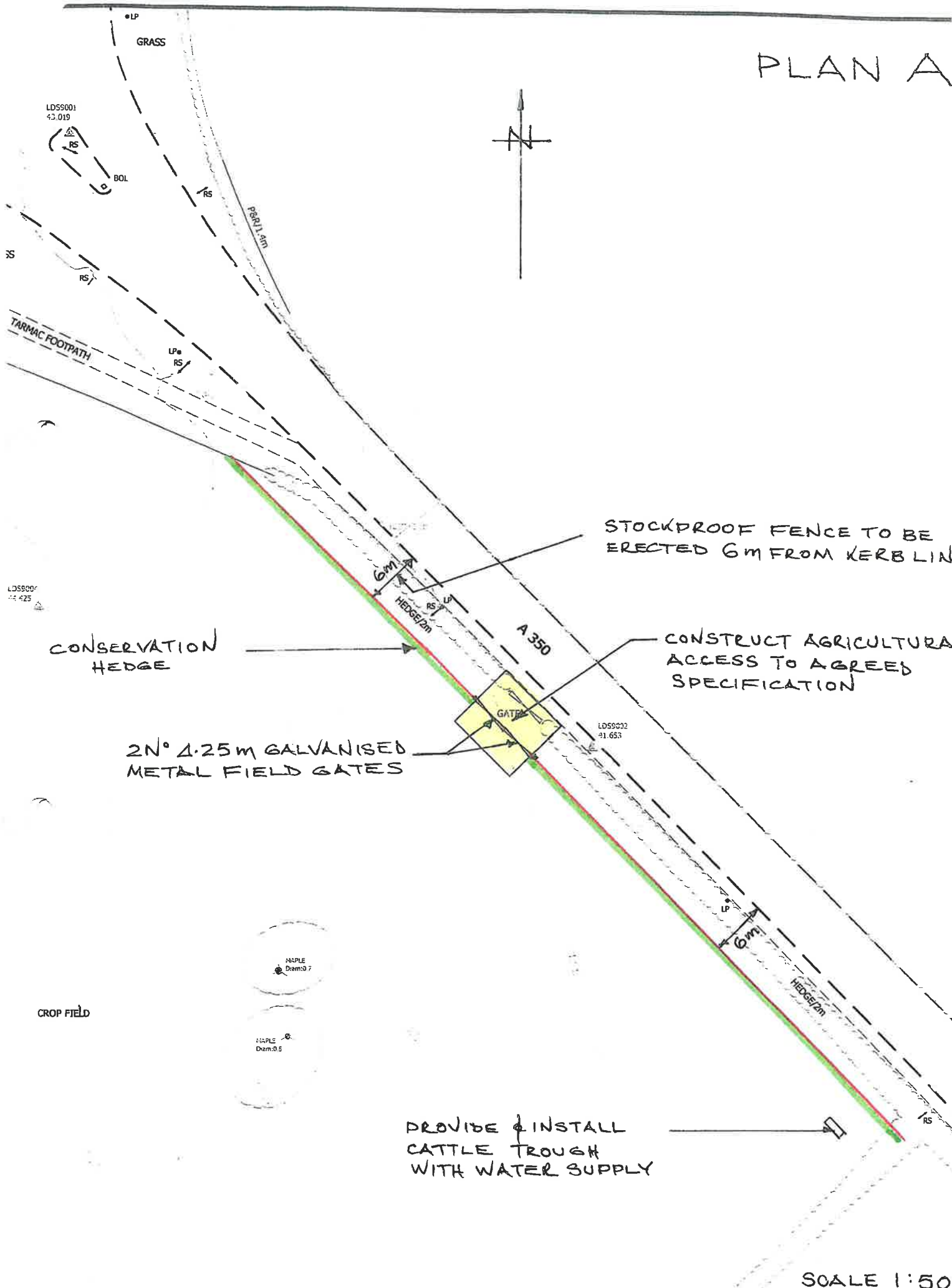

SCALE 1:500