



Proposed Changes to the Proposals Map

North Dorset Local Plan – 2011 to 2026 Part 1: Pre-submission Document

Settlements alphabetical order M to P

1. Introduction

- 1.1 This document includes a set of maps that shows the proposed changes to the Proposals Map of the North Dorset District Wide Local Plan (2003).
- 1.2 Policy 2 – Core Spatial Strategy of the North Dorset Local Plan 2011 to 2026 Part 1 states that the settlement boundaries around the four main towns will be retained. The settlement boundaries will be retained unaltered around: Blandford Forum and Blandford St Mary, (on Inset Maps 2 and 2A); Shaftesbury (Inset Maps 37 and 37A); and Sturminster Newton (Inset maps 47 and 47A).
- 1.3 The settlement boundary around Gillingham (Inset Maps 15 and 15A) will be retained unaltered except to the south of the town, where it will be amended to accommodate growth in the form of a Strategic Site Allocation (SSA). The retained settlement boundaries will continue to be used for development management purposes until reviewed either through the North Dorset Local Plan Part 2: Site Allocations or a neighbourhood plan.

Gillingham Southern Extension

- 1.4 The first map in this document is the Gillingham Southern Extension Proposals Map, which shows both the amended settlement boundary and the proposals for the development of the SSA. This map also appears as Figure 9.5 on page 261 of the main Pre-submission Document.

Removed Settlement Boundaries

- 1.5 Other maps show the boundaries of other settlements in the District that will be removed from the Proposals Map. A list of the settlements where the boundaries will be removed appears in Figure B.1 on pages 380 to 382 of the main Pre-submission Document.

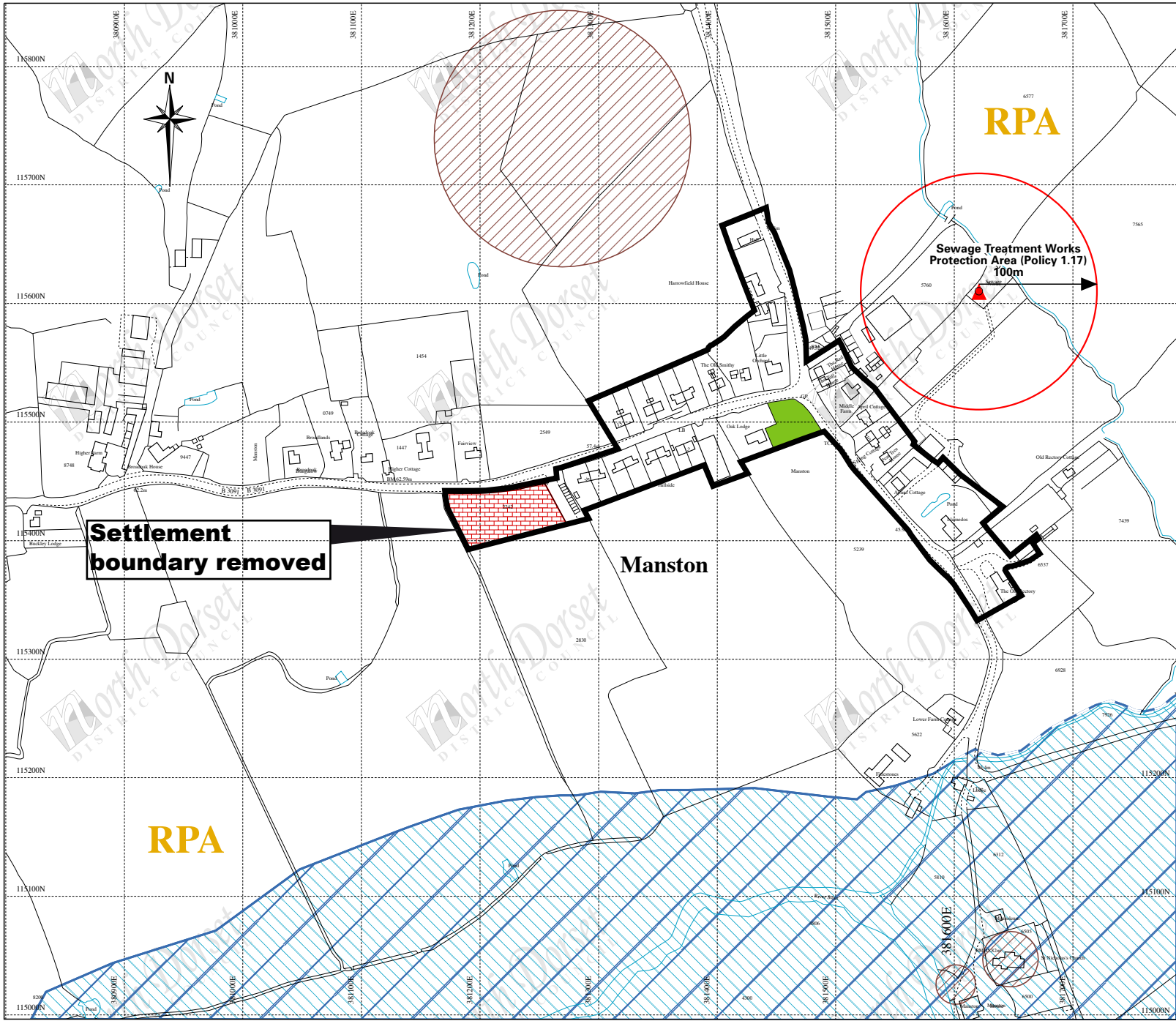

MANSTON		PROPOSALS MAP
		INSET No.
		26
		Policy Ref:
	Settlement Boundary	1. 7
	Important Open or Wooded Areas	1. 9
	River Valley Policy & Area Liable to Flood	1. 12 -13
	Sites of Archaeological Importance	1.26 - 28
	Blackmore Vale Landscape Character Area	1. 33
	Rural Priority Area (RPA)	3. 1
	Housing: Committed Site	2. 1

Settlement boundary removed

Sewage Treatment Works Protection Area (Policy 1.17) 100m

North Dorset
DISTRICT COUNCIL

Nordon, Salisbury Road, Blandford Forum, Dorset DT11 7LL
 Telephone (01258) 454111 Fax (01258) 480179

NORTH DORSET DISTRICT - WIDE LOCAL PLAN
(1st Revision)

© Crown copyright and database rights
 2013 Ordnance Survey LA100018415

Scale Adopted: Jan. 2003

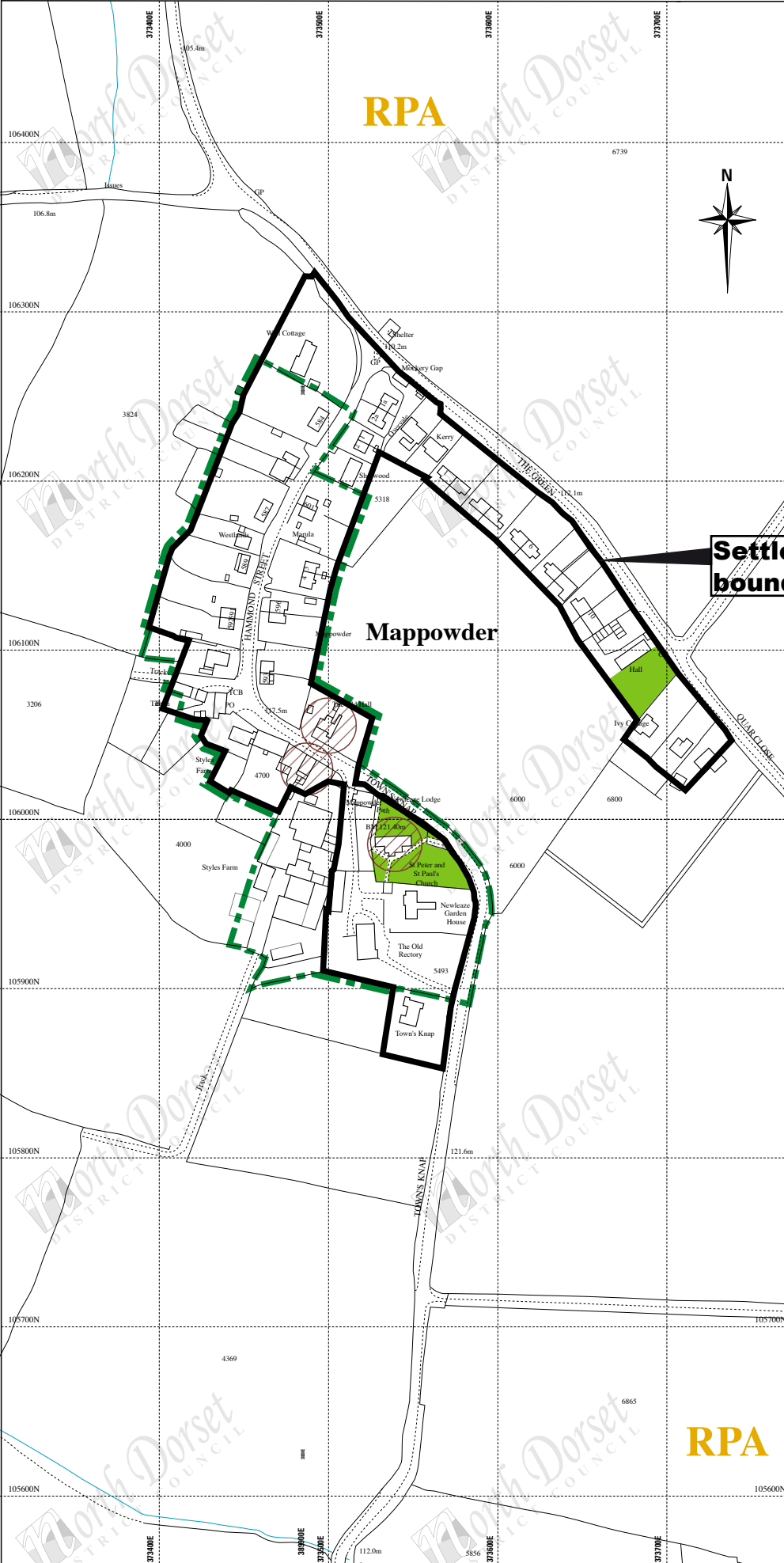

MAPPOWDER		PROPOSALS MAP	
		INSET No. 27	
		Policy Ref:	
	Settlement Boundary	1.7	
	Important Open or Wooded Areas	1.9	
	Conservation Area	1.24 - 27	
	Sites of Archaeological Importance	1.28 - 30	
Whole Inset Plan Area	Blackmore Vale Landscape Character Area	1.33	
	Rural Priority Area (RPA)	3.1	



Settlement boundary removed

North Dorset
DISTRICT COUNCIL

Nordon, Salisbury Road, Blandford Forum, Dorset DT11 7LL
 ● Telephone (01258) 454111 ● Fax (01258) 480179

NORTH DORSET DISTRICT - WIDE LOCAL PLAN (1st Revision)

© Crown copyright and database rights 2013 Ordnance Survey LA100018415

Scale Adopted: Jan. 2003

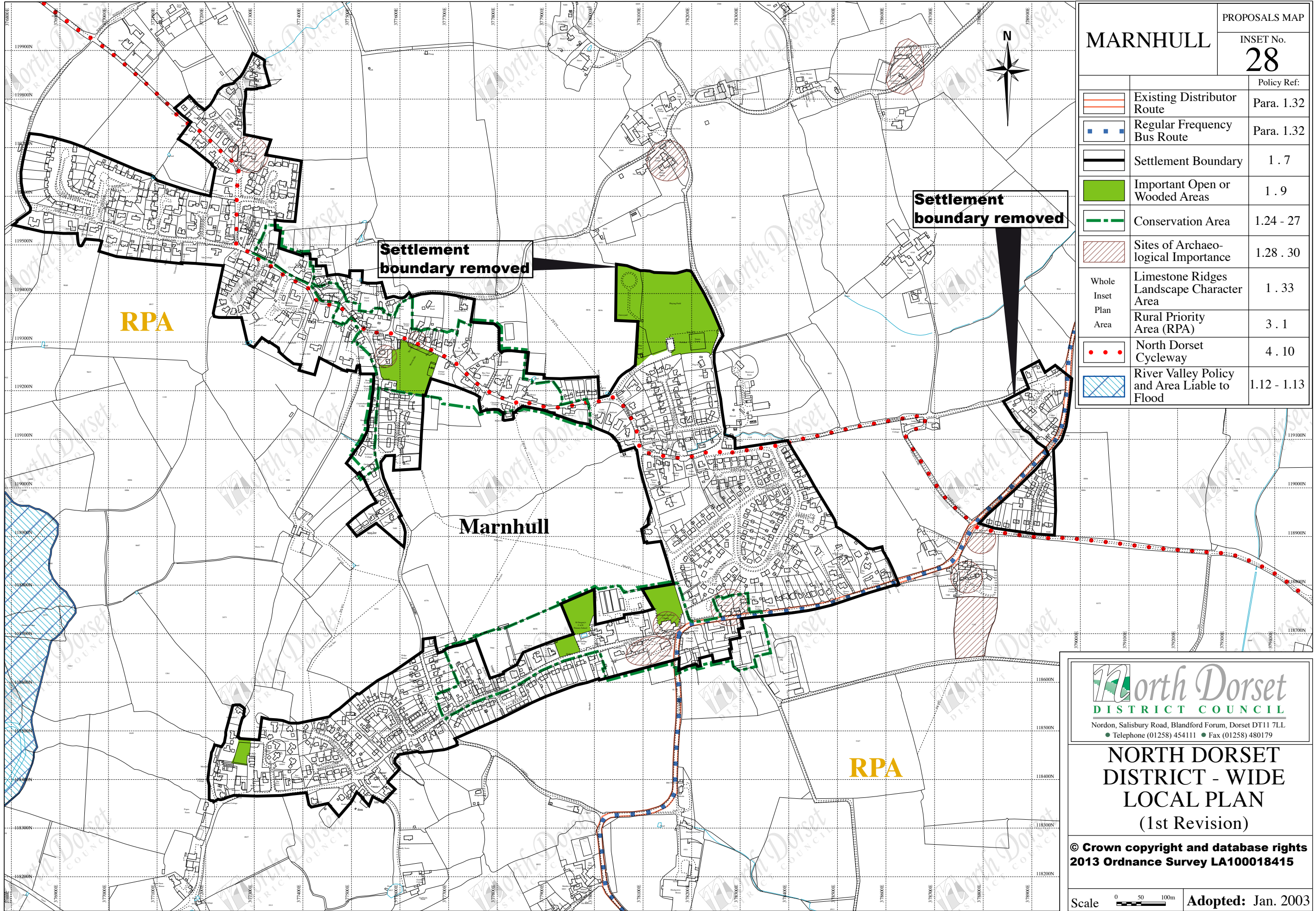

		Policy Ref:
	Existing Distributor Route	Para. 1.32
	Regular Frequency Bus Route	Para. 1.32
	Settlement Boundary	1.7
	Important Open or Wooded Areas	1.9
	Conservation Area	1.24 - 27
	Sites of Archaeological Importance	1.28 - 30
Whole Inset Plan Area	Limestone Ridges Landscape Character Area	1.33
	Rural Priority Area (RPA)	3.1
	North Dorset Cycleway	4.10
	River Valley Policy and Area Liable to Flood	1.12 - 1.13

Settlement boundary removed

Settlement boundary removed

RPA

Marnhull

RPA

North Dorset
DISTRICT COUNCIL

Nordon, Salisbury Road, Blandford Forum, Dorset DT11 7LL
 Telephone (01258) 454111 Fax (01258) 480179

NORTH DORSET DISTRICT - WIDE LOCAL PLAN
(1st Revision)

© Crown copyright and database rights
 2013 Ordnance Survey LA100018415

Scale 0 50 100m

Adopted: Jan. 2003

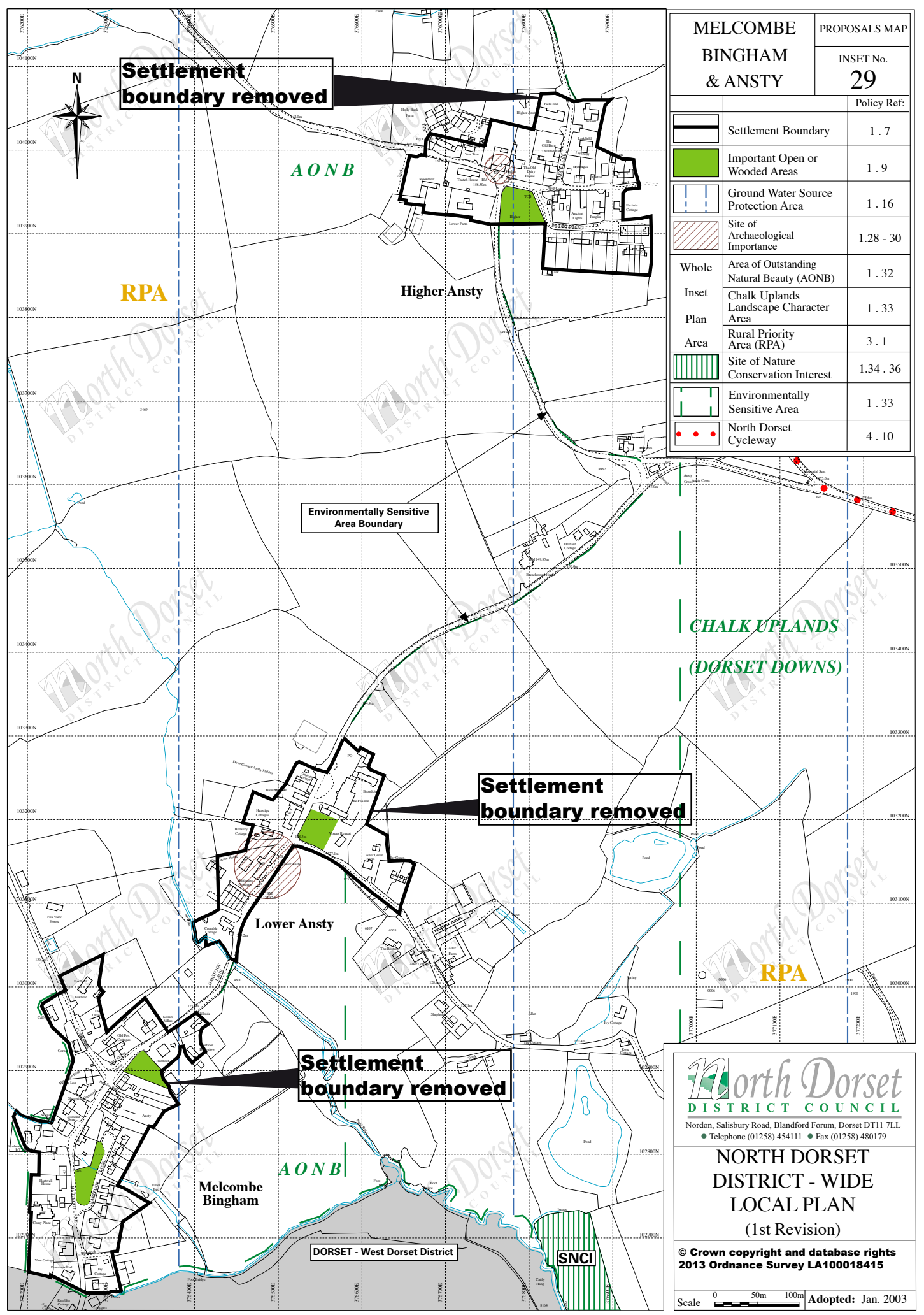

MELCOMBE BINGHAM & ANSTY
PROPOSALS MAP
 INSET No. **29**

		Policy Ref:
	Settlement Boundary	1.7
	Important Open or Wooded Areas	1.9
	Ground Water Source Protection Area	1.16
	Site of Archaeological Importance	1.28 - 30
Whole	Area of Outstanding Natural Beauty (AONB)	1.32
Inset	Chalk Uplands Landscape Character Area	1.33
Plan	Rural Priority Area (RPA)	3.1
Area	Site of Nature Conservation Interest	1.34 - 36
	Environmentally Sensitive Area	1.33
	North Dorset Cycleway	4.10

Settlement boundary removed

Settlement boundary removed

Settlement boundary removed











CHALK UPLANDS (DORSET DOWNS)

North Dorset DISTRICT COUNCIL
 Nordon, Salisbury Road, Blandford Forum, Dorset DT11 7LL
 ● Telephone (01258) 454111 ● Fax (01258) 480179

NORTH DORSET DISTRICT - WIDE LOCAL PLAN (1st Revision)

© Crown copyright and database rights 2013 Ordnance Survey LA100018415

Scale Adopted: Jan. 2003

		Policy Ref:
	Existing Distributor Route	Para.1.32
	Regular Frequency Bus Route	Para.1.32
	Settlement Boundary	1.7
	Important Open or Wooded Area	1.9
	River Valley Area	1.12
	Ground Water Source Protection Area	1.16
	Conservation Area	1.24 - 27
	Sites of Archaeological Importance	1.28 - 30
Whole Inset Plan Area	Part Chalk River Valley and Part Chalk Uplands Landscape Character Area Rural Priority Area (RPA)	1.33 3.1
	Housing : Committed Site	2.1
	Employment : Existing Site	3.2 - 3.3

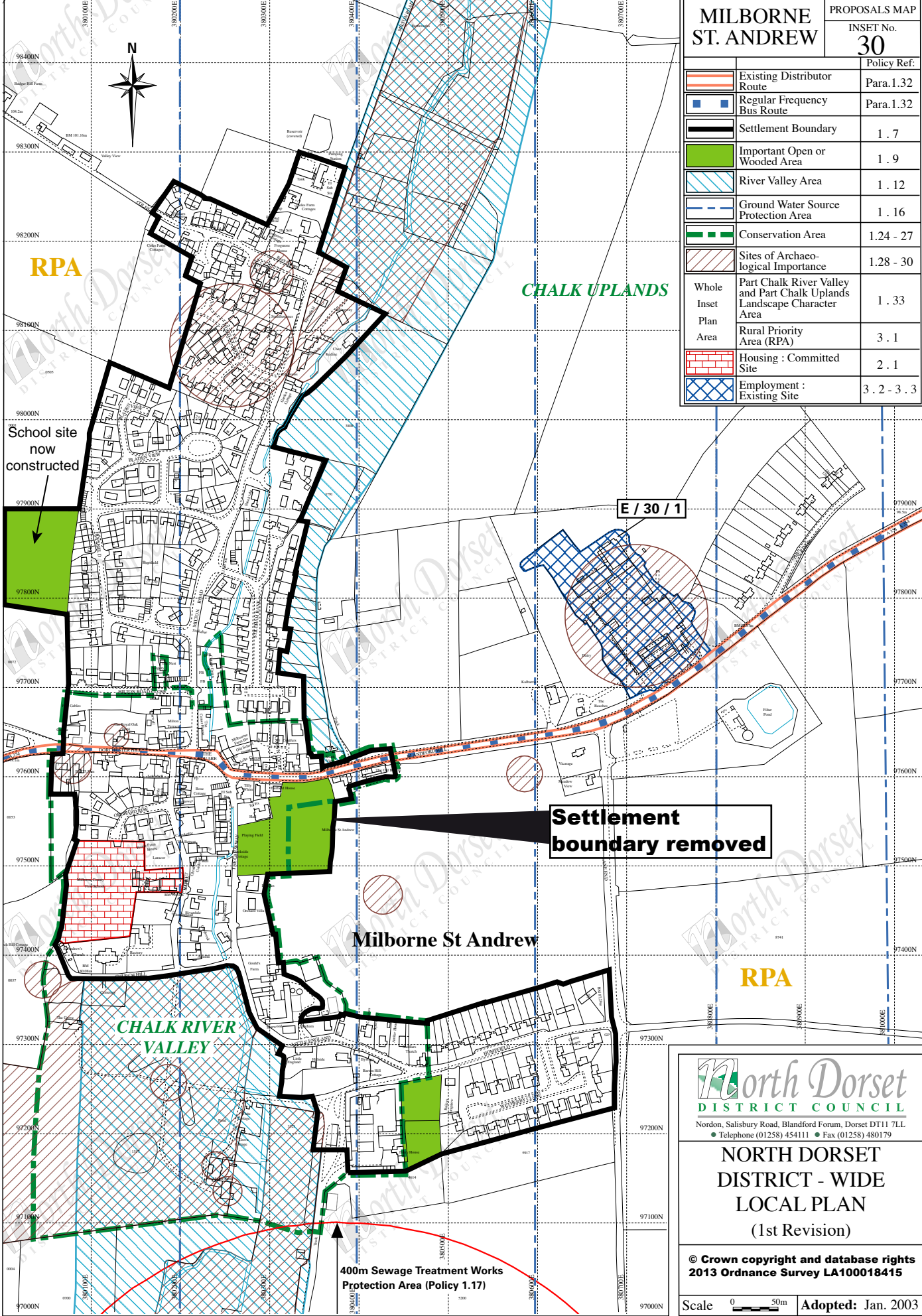

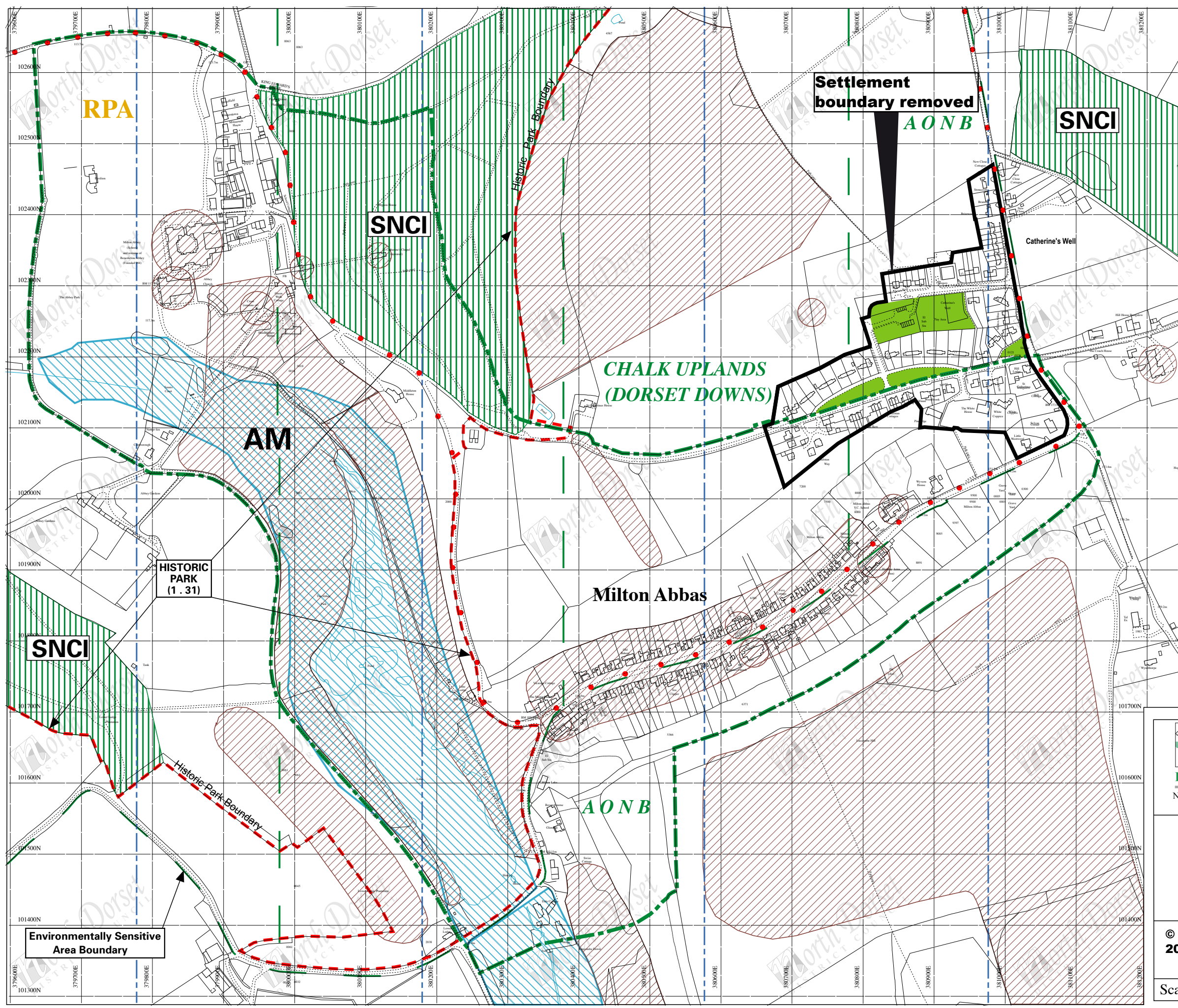

MILTON ABBAS

PROPOSALS MAP

INSET No. **31**

		Policy Ref:
	Settlement Boundary	1.7
	Important Open or Wooded Areas	1.9
	River Valley Policy	1.12
	Ground Water Source Protection Area	1.16
	Conservation Area	1.22 - 25
	Ancient Monuments(AM) and Sites of Archaeological Importance	1.28 . 30
Whole	Area of Outstanding Natural Beauty (AONB)	1.32
Inset	Chalk Uplands Landscape Character Area	1.33
Plan	Rural Priority Area (RPA)	3.1
Area	Environmentally Sensitive Area	1.33
	Site of Nature Conservation Interest	1.34 - 36
	North Dorset Cycleway	4.10

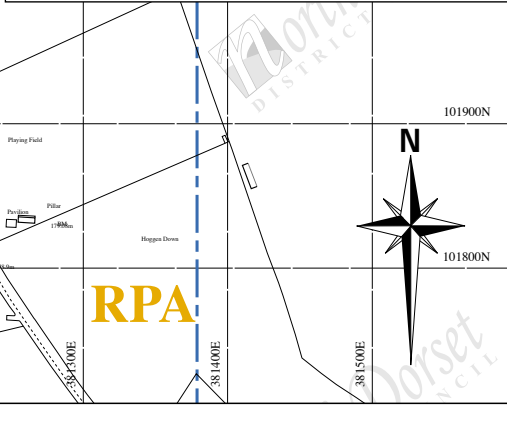

North Dorset DISTRICT COUNCIL

Nordon, Salisbury Road, Blandford Forum, Dorset DT11 7LL

• Telephone (01258) 454111 • Fax (01258) 480179

NORTH DORSET DISTRICT - WIDE LOCAL PLAN (1st Revision)







© Crown copyright and database rights 2013 Ordnance Survey LA100018415

Scale 0 50m 100m **Adopted: Jan. 2003**

MILTON ON STOUR

PROPOSALS MAP

INSET No.
32

	Existing Distributor Route	Para. 1.32
	Regular Frequency Bus Route	Para. 1.32
	Settlement Boundary	1.7
	Important Open or Wooded Areas	1.9
	River Valley Area & Area Liable to Flood	1.12 - 13
	Conservation Area	1.24 - 27
	Sites of Archaeological Importance	1.28 - 30
Whole Inset Plan Area	Blackmore Vale Landscape Character Area	1.33
	Rural Priority Area (RPA)	3.1
	Drainage Requirement	MS 1



Settlement boundary removed

RPA

BLACKMORE VALE

Policy GH24 Footway Provision

Milton on Stour

RPA

Footway/Bridleway Link Policy MS2

North Dorset DISTRICT COUNCIL
 Nordon, Salisbury Road, Blandford Forum, Dorset DT11 7LL
 Telephone (01258) 454111 Fax (01258) 480179

NORTH DORSET DISTRICT - WIDE LOCAL PLAN (1st Revision)

© Crown copyright and database rights 2013 Ordnance Survey LA100018415

Scale  Adopted: Jan. 2003

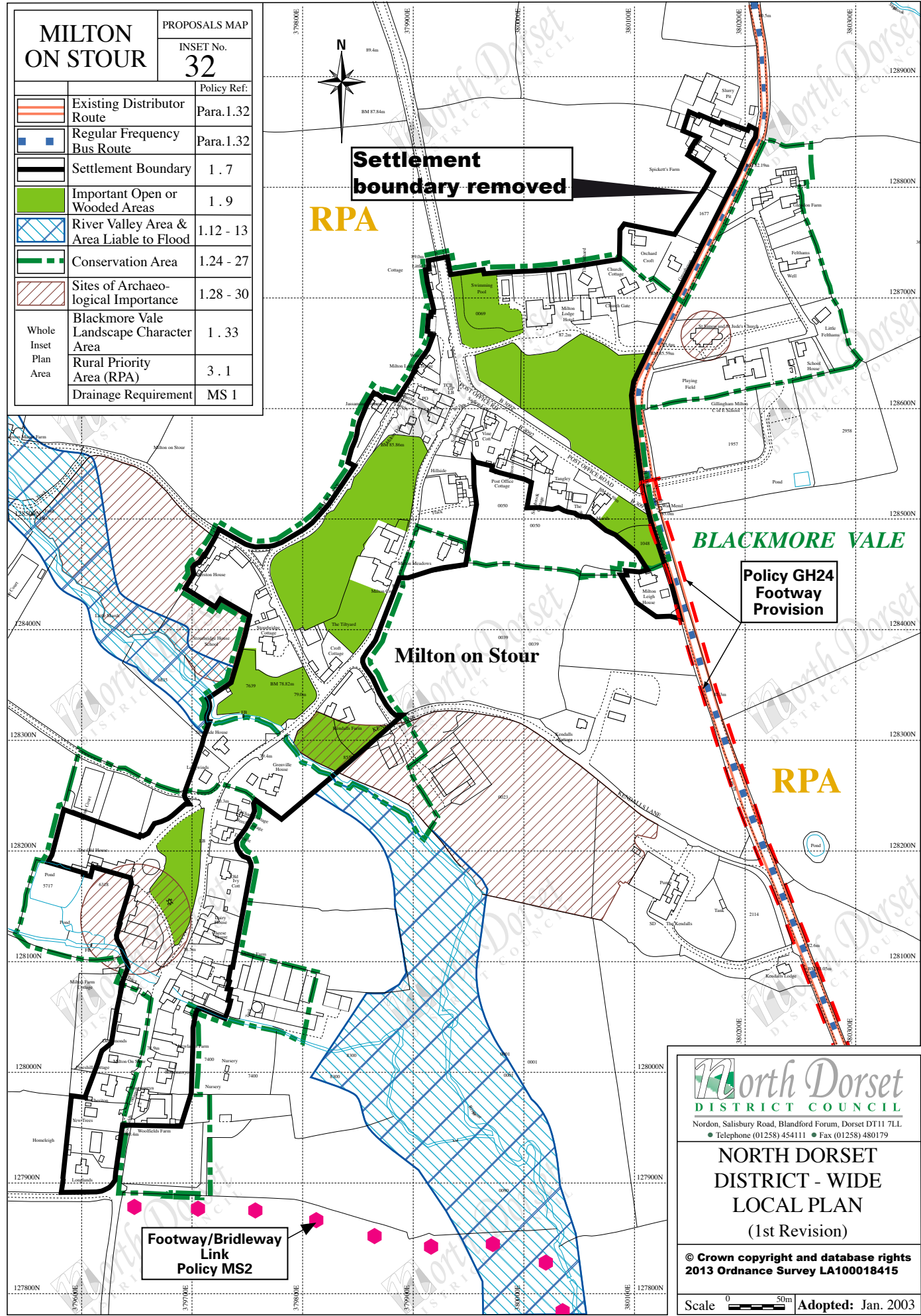

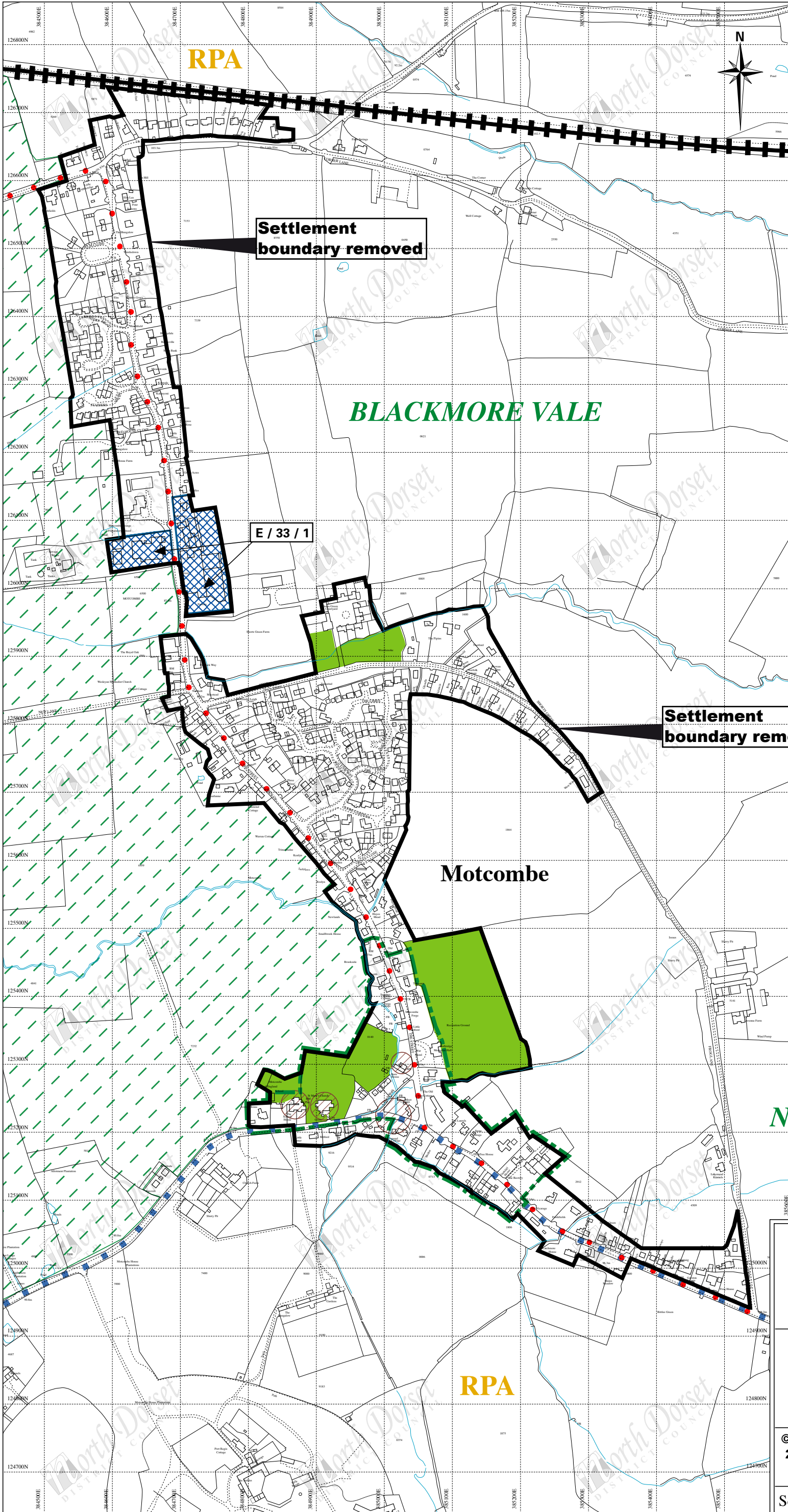

MOTCOMBE		PROPOSALS MAP
		INSET No. 33
		Policy Ref:
	Railtrack	Para.1 . 32
	Regular Frequency Bus Service	Para.1 . 32
	Settlement Boundary	1 . 7
	Important Open or Wooded	1 . 9
	Conservation Area	1 . 24 - 27
	Sites of Archaeological Importance	1 . 28 - 30
Whole Inset Plan Area	Part Blackmore Vale Part Northern Scarp Hills Landscape Character Areas Rural Priority Area (RPA) Drainage Requirement	1 . 33 3 . 1 MC 1
	Site of Nature Conservation Interest	1 . 34 - 37
	Employment: Committed Site	3 . 2 - 3 . 3
	North Dorset Cycleway	4 . 10
	Gillingham Royal Forest Project Area	GRF 1

North Dorset
DISTRICT COUNCIL

Nordon, Salisbury Road, Blandford Forum, Dorset DT11 7LL
 Telephone (01258) 454111 Fax (01258) 480179

NORTH DORSET DISTRICT - WIDE LOCAL PLAN
(1st Revision)

© Crown copyright and database rights
2013 Ordnance Survey LA100018415

Scale Adopted: Jan. 2003

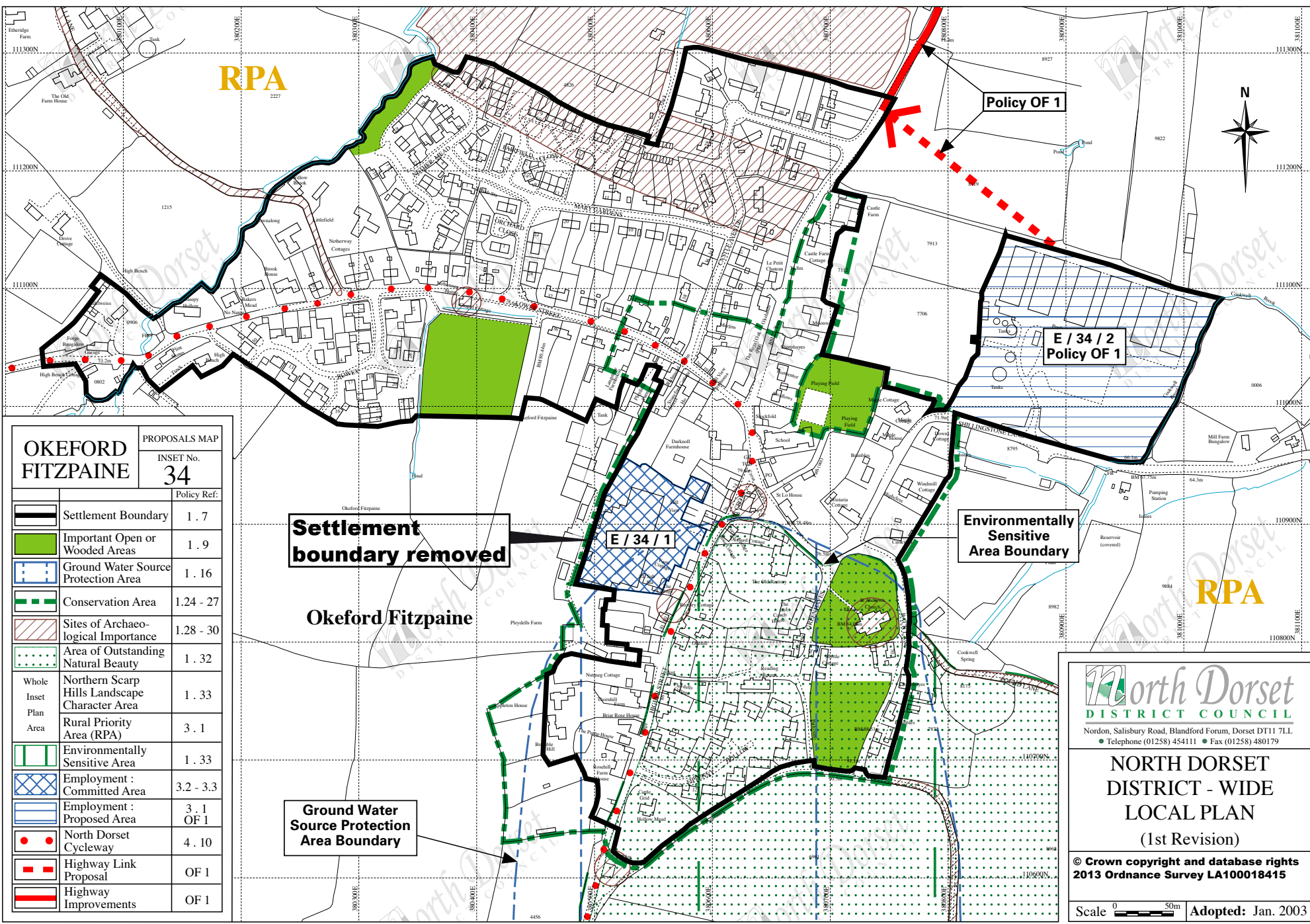

RPA
227

Policy OF 1

E / 34 / 2
Policy OF 1

Settlement
boundary removed

Environmentally
Sensitive
Area Boundary

Okeford Fitzpaine

E / 34 / 1

RPA

OKEFORD FITZPAINE
PROPOSALS MAP
INSET No. **34**

	Policy Ref:	
Settlement Boundary	1. 7	
Important Open or Wooded Areas	1. 9	
Ground Water Source Protection Area	1. 16	
Conservation Area	1.24 - 27	
Sites of Archaeological Importance	1.28 - 30	
Area of Outstanding Natural Beauty	1. 32	
Whole Inset Plan Area	Northern Scarp Hills Landscape Character Area	1. 33
	Rural Priority Area (RPA)	3. 1
Environmentally Sensitive Area	1. 33	
Employment : Committed Area	3.2 - 3.3	
Employment : Proposed Area	3. 1 OF 1	
North Dorset Cycleway	4. 10	
Highway Link Proposal	OF 1	
Highway Improvements	OF 1	

Ground Water
Source Protection
Area Boundary

North Dorset
DISTRICT COUNCIL

Nordon, Salisbury Road, Blandford Forum, Dorset DT11 7LL
● Telephone (01258) 454111 ● Fax (01258) 480179

**NORTH DORSET
DISTRICT - WIDE
LOCAL PLAN
(1st Revision)**

© Crown copyright and database rights
2013 Ordnance Survey LA100018415

Scale 0 50m Adopted: Jan. 2003

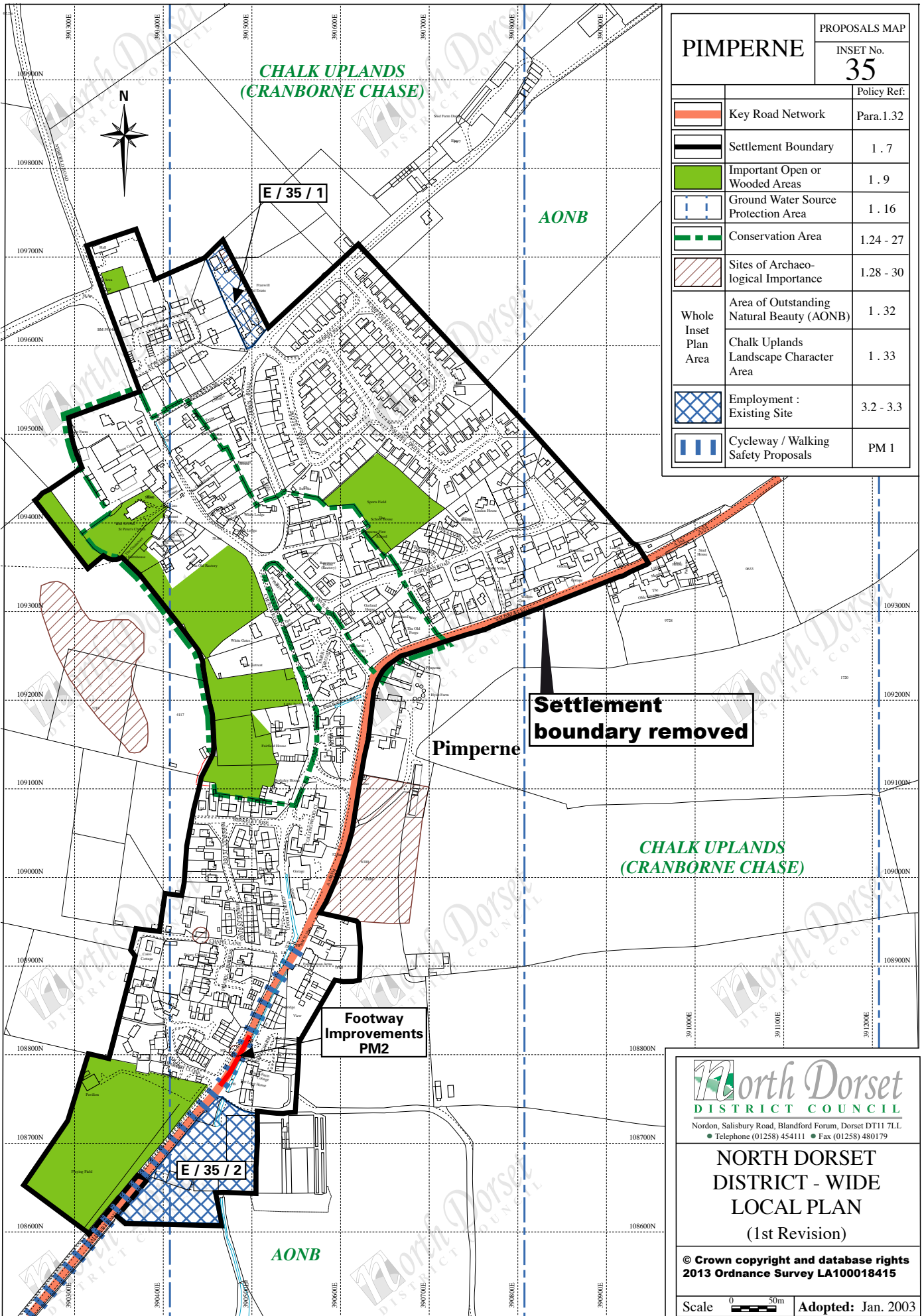

PIMPERNE

PROPOSALS MAP
INSET No. **35**

		Policy Ref:
	Key Road Network	Para.1.32
	Settlement Boundary	1.7
	Important Open or Wooded Areas	1.9
	Ground Water Source Protection Area	1.16
	Conservation Area	1.24 - 27
	Sites of Archaeological Importance	1.28 - 30
	Area of Outstanding Natural Beauty (AONB)	1.32
	Chalk Uplands Landscape Character Area	1.33
	Employment : Existing Site	3.2 - 3.3
	Cycleway / Walking Safety Proposals	PM 1

Settlement boundary removed

Footway Improvements PM2

E / 35 / 1

E / 35 / 2

North Dorset
DISTRICT COUNCIL
Nordon, Salisbury Road, Blandford Forum, Dorset DT11 7LL
• Telephone (01258) 454111 • Fax (01258) 480179

NORTH DORSET DISTRICT - WIDE LOCAL PLAN
(1st Revision)

© Crown copyright and database rights
2013 Ordnance Survey LA100018415

Scale Adopted: Jan. 2003

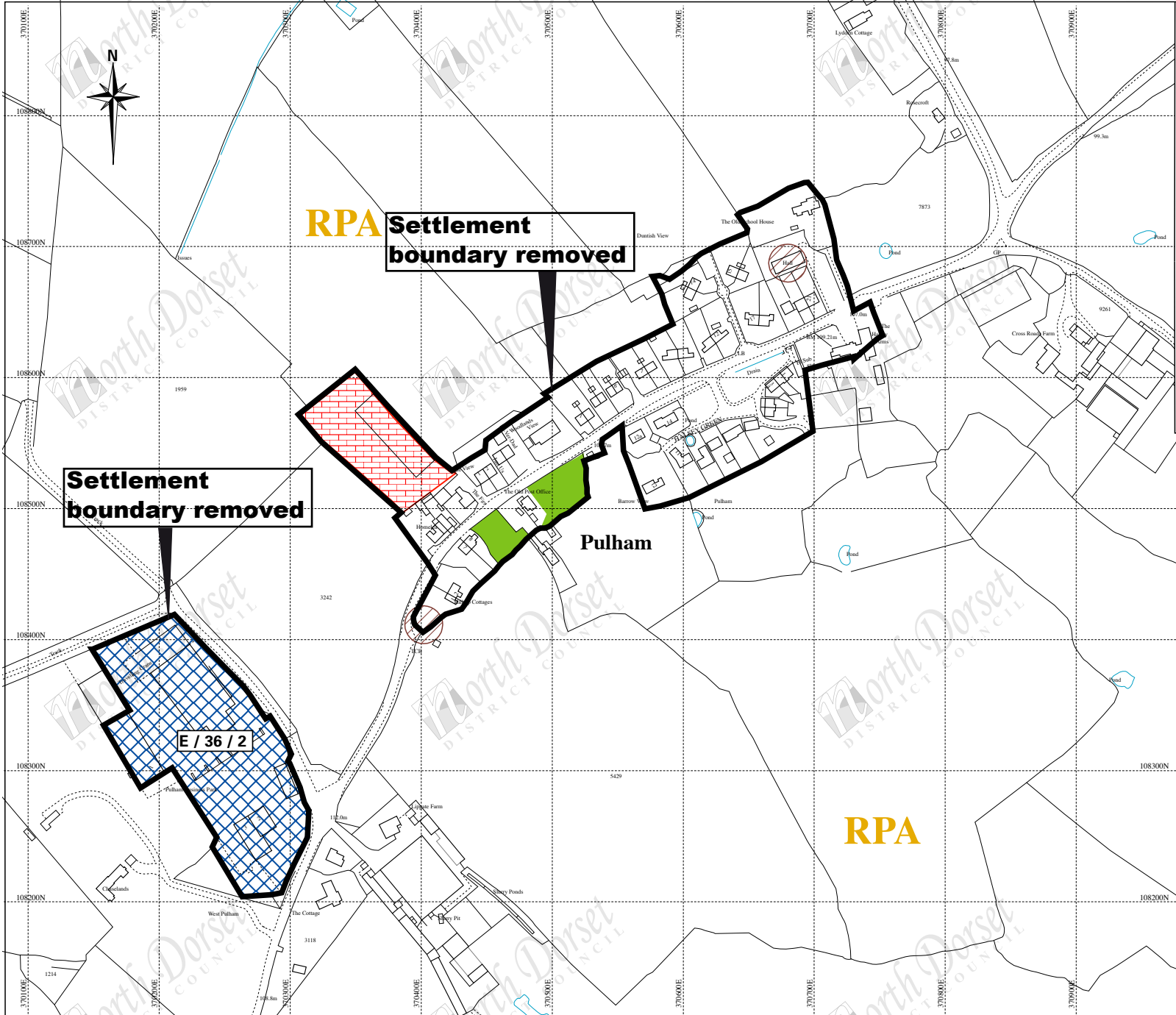

PULHAM		PROPOSALS MAP
		INSET No.
		36
		Policy Ref:
	Settlement Boundary	1.7
	Important Open or Wooded Areas	1.9
	Sites of Archaeological Importance	1.28 - 30
Whole Inset Plan Area	Blackmore Vale Landscape Character Area	1.33
	Rural Priority Area (RPA)	3.1
	Site of Nature Conservation Interest	1.34 - 36
	Housing : Committed Site	2.1
	Employment : Committed Site	3.2 - 3.3

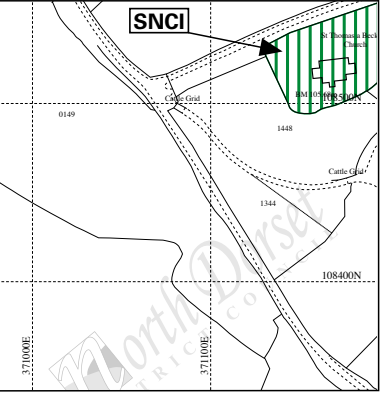

North Dorset DISTRICT COUNCIL
 Nordon, Salisbury Road, Blandford Forum, Dorset DT11 7LL
 Telephone (01258) 454111 Fax (01258) 480179

NORTH DORSET DISTRICT - WIDE LOCAL PLAN (1st Revision)

© Crown copyright and database rights 2013 Ordnance Survey LA100018415

Scale Adopted: Jan. 2003



Planning Policy
North Dorset District Council
Nordon
Salisbury Road
Blandford Forum
DT11 7LL

www.dorsetforyou.com

Published November 2013

© North Dorset District Council 2013