

Appendix 2 – Suttle Stone Quarries case studies

Purbeck District Council and Dorset County Council's Dorset Innovation Park, Winfrith, Dorset

Suttle Stone Quarries supplied over 7,000 tonnes of crushed limestone from Swanworth Quarry for the ongoing construction of the award-winning Dorset Innovation Park in 2017.

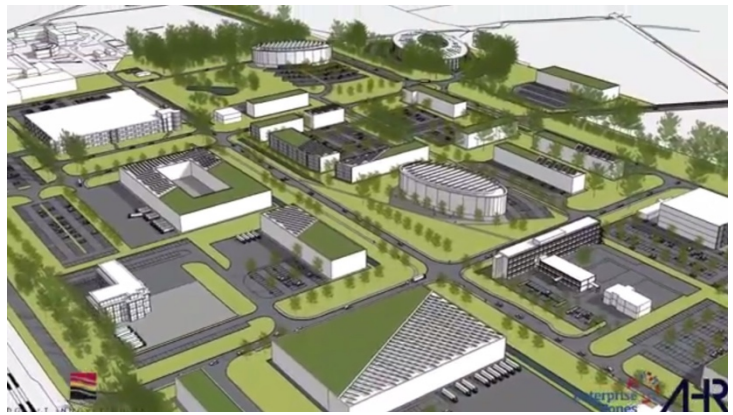

The stone was used in the construction of the sub-base for the new units, as well as in the road and car parking areas. Grades of clean limestone were selected from

Swanworth's range in order to meet specs required for permeable surfaces at the site.



The Dorset Innovation Park was recognized with a prestigious award from the

Federation of Small Businesses and Purbeck District Council (PDC) and Dorset County Council (DCC) won the award for the most innovative 'small business friendly programme or project'. The park, which is the county's second largest employment site - received Enterprise Zone status in April.



The employment park, which accommodates 56 hectares of employment land and includes twenty new employment units, is part of a £2.5m workspace project launched by PDC and County Hall.

Royal Bournemouth Hospital Helipad, Dorset - Swanworth gabion stone



Suttle Stone Quarries supplied gabion Limestone for a helipad extension at Royal Bournemouth Hospital, Dorset. The site was reconstructed so that larger helicopters can land there rather than being sent further afield.

The redevelopment of the pad used 100-200mm size limestone sourced from Swanworth quarry to fill gabion baskets that made up the outer retaining walls of the pad.



Dorset Wildlife Trust- Greengage Project – Swanworth 10mm to Dust crushed limestone



A community gardening project in Swanage received a helping hand from Suttle Stone Quarries in the form of a donation of 20 tonnes of 10mm-dust crushed limestone.

The garden, at Prospect Crescent, offers therapeutic horticulture sessions for a range of people including those recovering from mental health issues, long-term unemployed, and people living with dementia.



Aimed at promoting health and wellbeing in individuals, the community ecotherapy facility needed the crushed limestone to level out the surface in a greenhouse.



Katie Wilkinson, from the Dorset Wildlife Trust, said: “In order for people involved in this project to work here safely, it was really important to get floor of the greenhouse even and safe, so it’s going to make this space so much more functional and useful. It’s going to be packed down, nice and flat, and will allow for all sorts of

raised beds and standing gardens to be established.”

Cobnor Point Habitat Regeneration, Chichester Harbour, West Sussex – Swanworth Rock Armour and Gabion Stone

Suttle Stone Quarries, delivered 3000 tonnes of Swanworth’s rock armour and 800 tonnes of 100-200mm (6G) Gabion Stone to Cobnor Point, Chidham, nr Chichester in West Sussex.

The scheme was undertaken by Land & Water Ltd and the work comprised of re-profiling the site, excavation, landscaping and



construction of two breaches with footbridge design and construction across the breaches, to allow salt water onto the mud flats.

Our rock armour stone was used as a buffer around the perimeter of the site to provide protection to the newly created ponds and mud flats, ensuring the ecosystems were not disturbed. The large rocks help to trap and slow the flow of water to prevent any removal of sediment from within



the mudflats or ponds. Since installation, the area has been clear of flooding and species have managed to make a strong foothold in developing their habitats on the mudflats.

Prospect Park Recycling Centre, Swanage, Dorset – Swanworth gabion stone



Suttle Stone Quarries, provided 100-200mm Gabion Limestone for filling Gabion Basket retaining walls at the new household recycling depot in Swanage for work completed by Raymond Brown Construction for Dorset County Council in 2012.

The Swanworth limestone was chosen as an economical retaining wall solution that only had to be hauled the 4 miles from its source to the Swanage recycling centre. Using local materials was key to the project, so the gabion limestone from Swanworth was a sympathetic choice which provides a unique, modern aesthetic to the Recycling Centre.



National Trust restoration works, Purbeck, Dorset – Swanworth Type 1 Dorset Variant Limestone



Suttle Stone Quarries supply numerous contracts for the National Trust, with thousands of tonnes of our limestone from Swanworth Quarry being supplied to the Purbeck area. After years of erosion by locals and visitors over the surface of tracks and car parks, there is a need for restoring with the same material that has been used for centuries. As always

the National Trust look to source local materials so choose to top the tracks with our Swanworth Limestone. The process of restoring road ways and tracks on National Trust land is an ongoing necessity in Purbeck. Crucial examples of Suttle Stone Quarries meeting this requirement with Swanworth Stone are:

- 2014 'Priests' Way' restoration works.

Using 100-200mm 6G Fill Limestone and Type 1 Dorset Variant sub base to level the ancient track and dress the top surface. The restoration of this historic footpath allows visitors, walkers and cyclists to continue to enjoy



the countryside with the traditional aesthetic that has been maintained for centuries, whilst maintaining a solid safe surface with modern techniques.

- 2015-16 'New Line' track

Track near Corfe Castle was badly in need of restoration and 300 tonnes of Swanworth Type 1 was supplied quickly and efficiently to the job which was only 5 miles away. 15 lorry movements were used to complete the job, which would not have been achievable with alternative materials or haulage.